

Assembly Instruction

ARTIKEL: postelja STRUMF 120X200

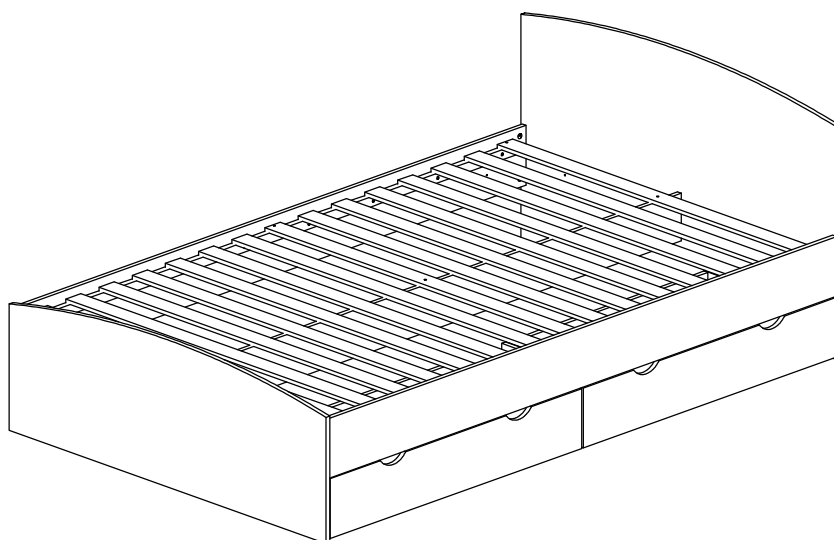

SESTAVNI DELI

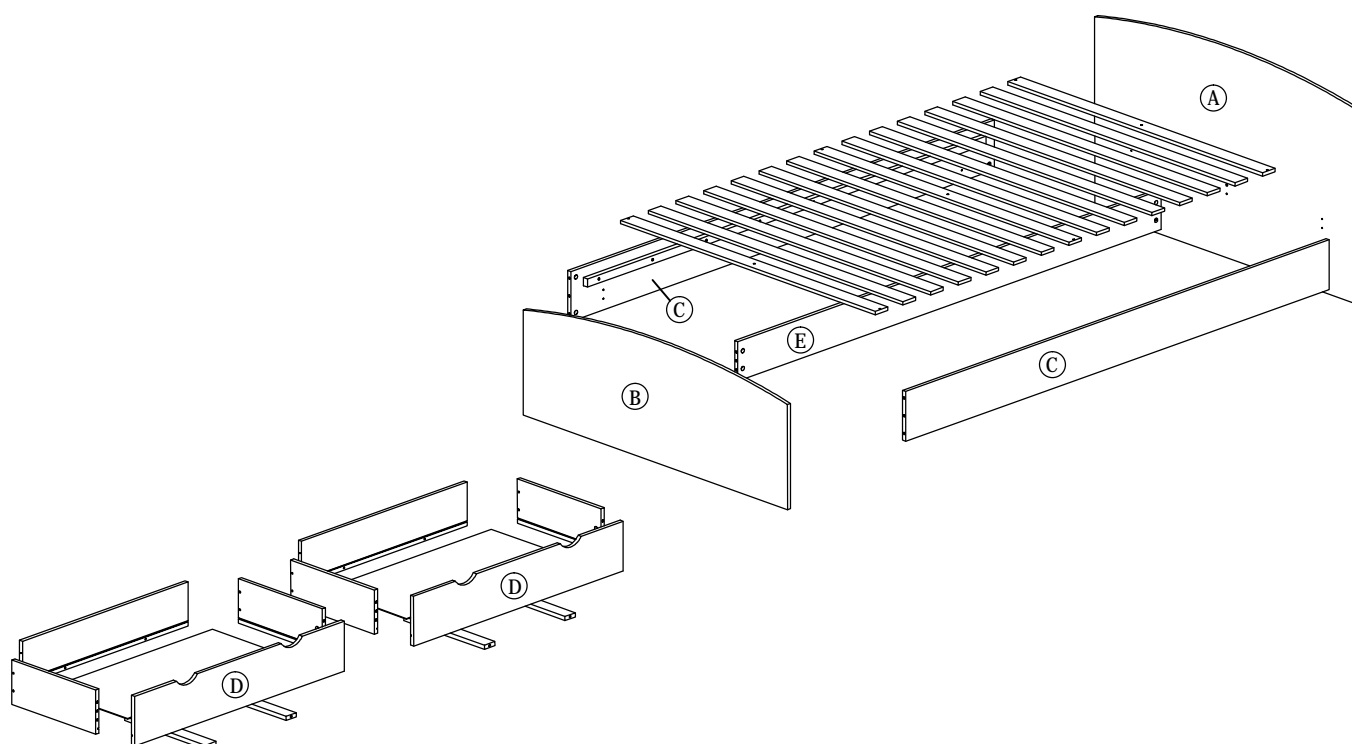

Assembly Instruction

SEZNAM SESTAVNIH DELOV

No.	OBLIKA	OPIS	Qty.
1		8x25mm LESENI MOZNIK	14Pcs
2		15MM ZATIČNI VIJAK	20Sets
3		15mm ČEP ZATIČNEGA VIJAKA	4Pcs
4		M4x38mm VIJAK	12Pcs
5		M3.5x16mm VIJAK	16Pcs
6		Pravokotni nosilec	4Pcs
7		TP 10#x1/2" VIJAK	16Pcs
8		Kolesčki za predal	8Pcs
9		Podnožni žebliček	4Pcs
10		M4 x 30mm VIJAK	9Pcs

NAMESTITEV VLOŽKA ZATIČNEGA VIJAKA

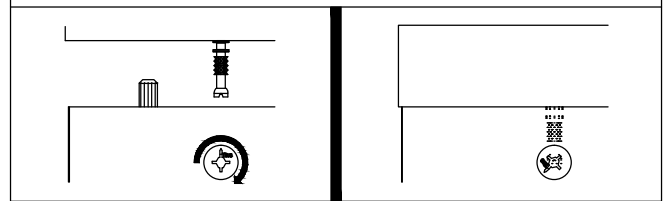

Korak 1

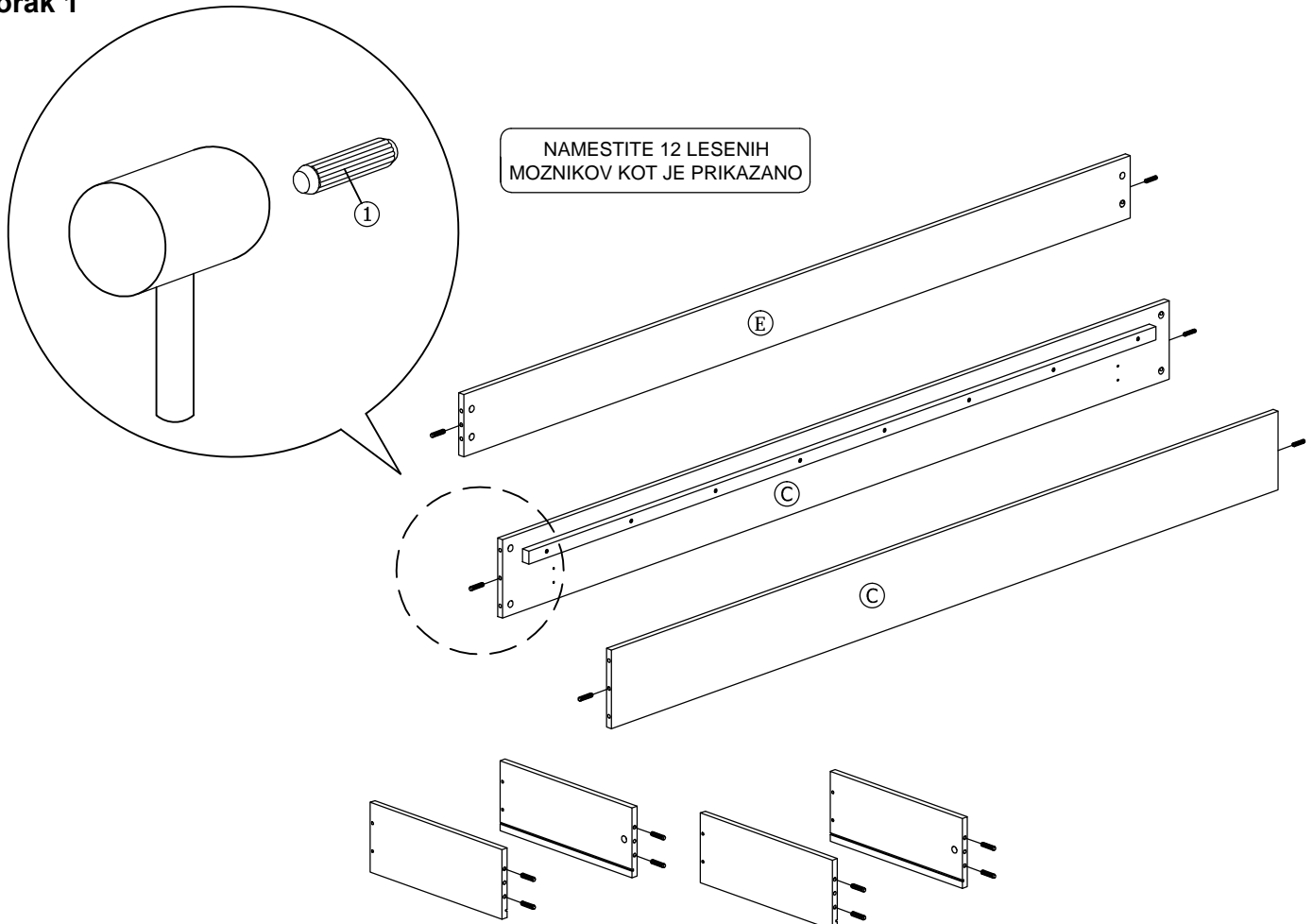

Assembly Instruction

Korak 2

NAMESTITE ZATIČNI VIJAK
KOT JE PRIKAZANO

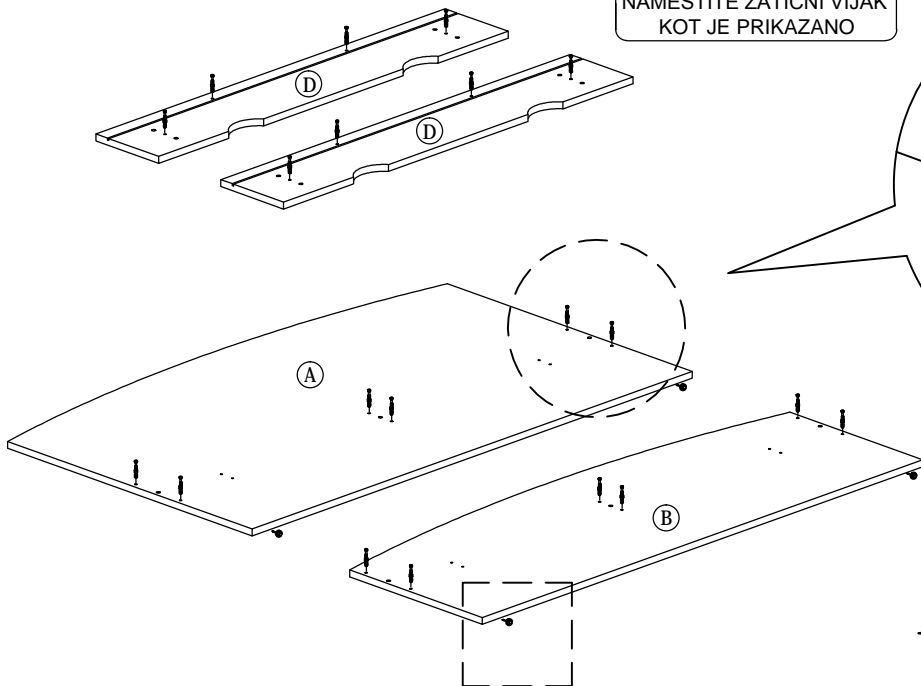

Pritrdite vse podnožne žebličke na vzglavno
in nožno stranico kot je prikazano na sliki

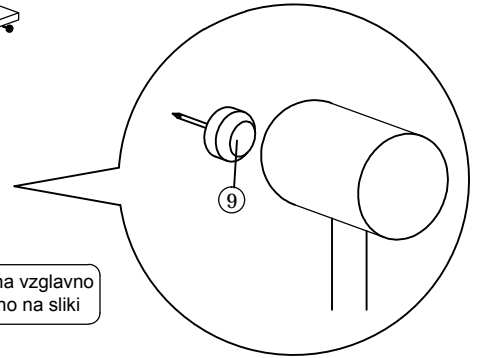

Korak 3

Namestite stranske pravokotne stranice med
vzglavno in nožno stranico ter jih pritrdite z
zatičnim vijakom , kot je prikazano na sliki

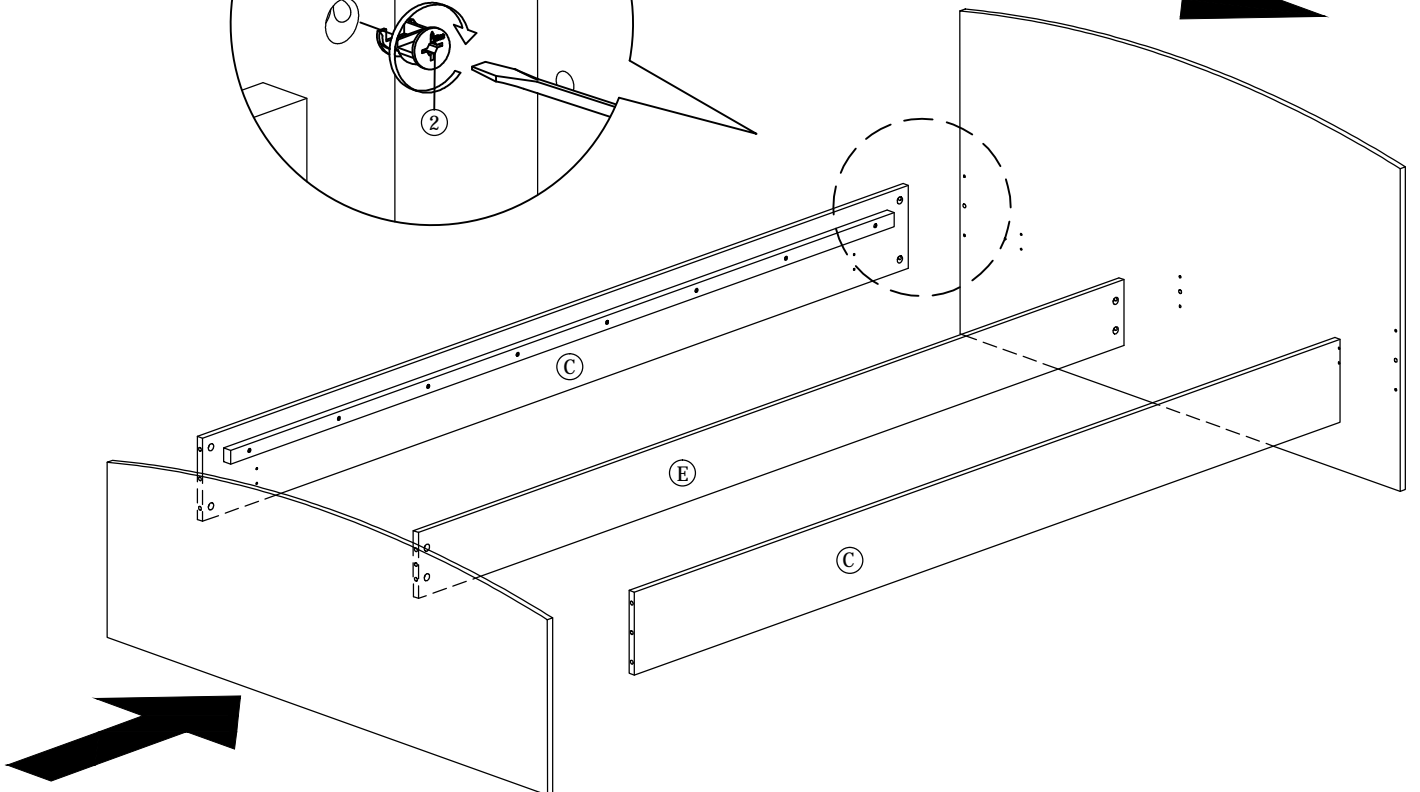
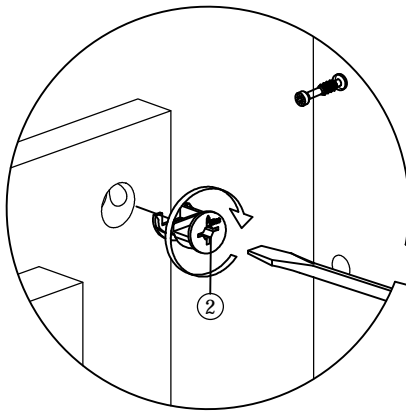

Assembly Instruction

Korak 4

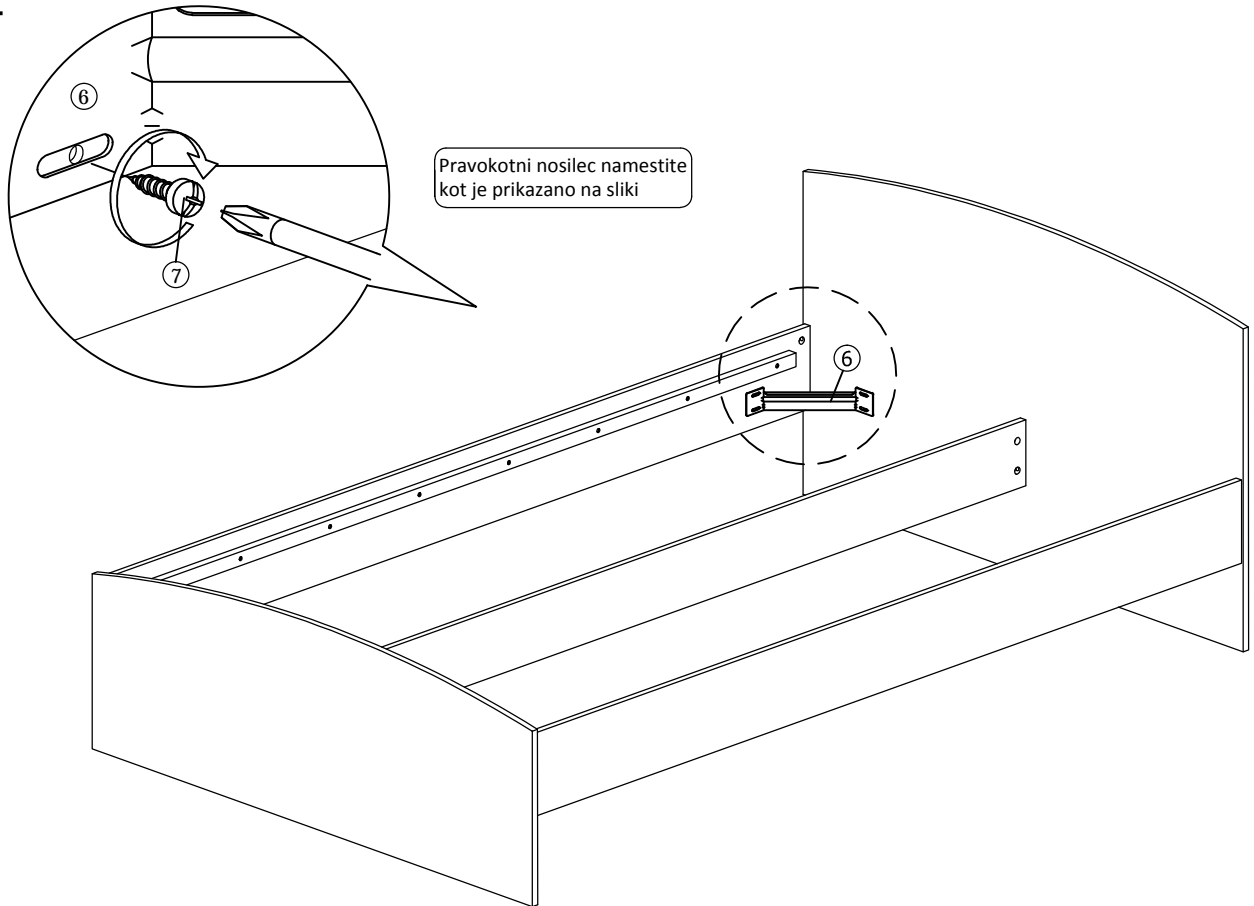

Korak 5

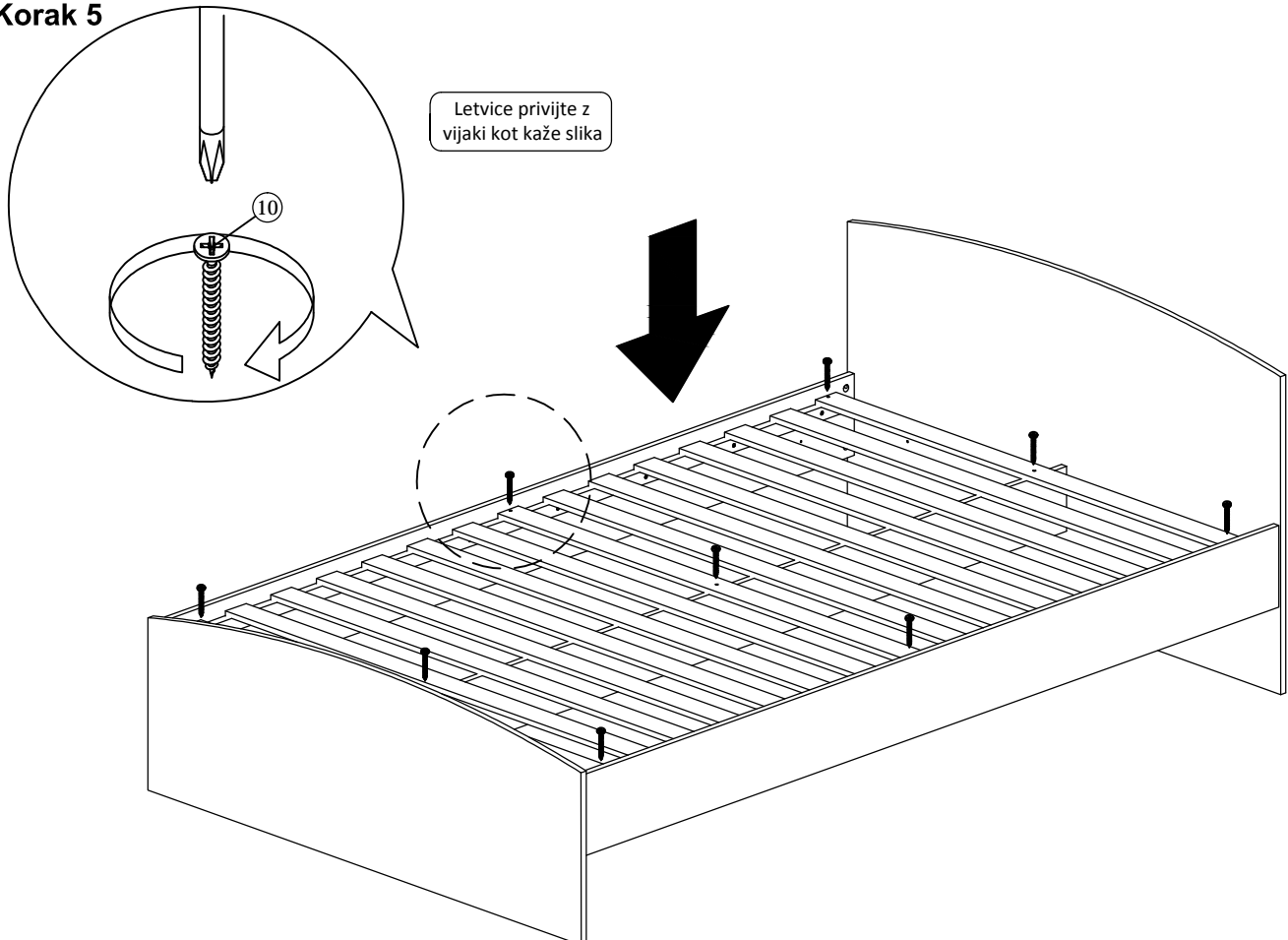

Assembly Instruction

Korak 6

namestite dno predala
kot je prikazano na sliki

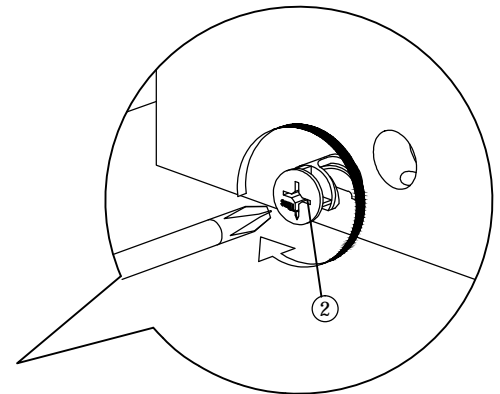
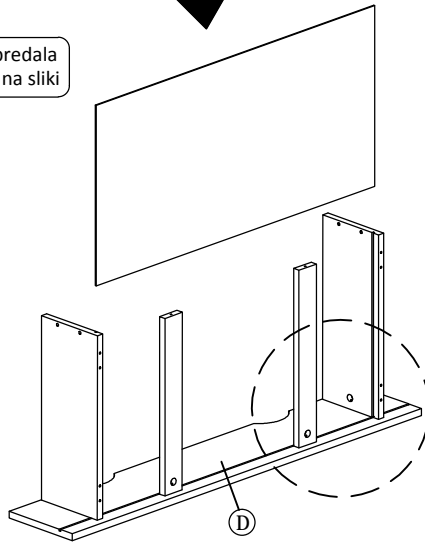

sestavite stranice predala in jih pritrdite
z zatičnim vijakom kot je prikazano

Korak 7

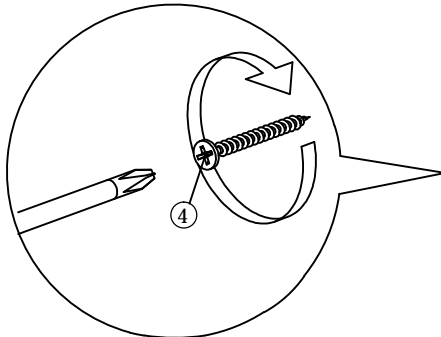

zadnjo stranico privijte
z vijaki kot je prikazano

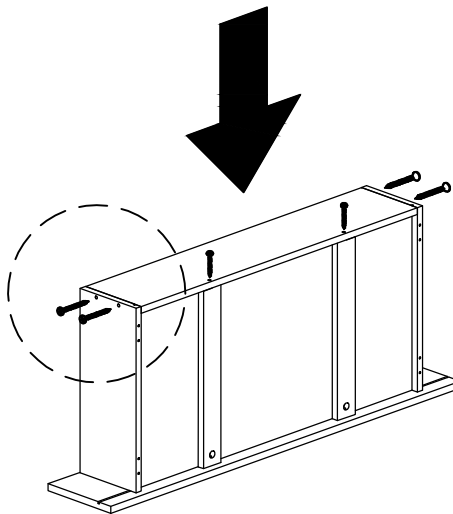

Korak 8

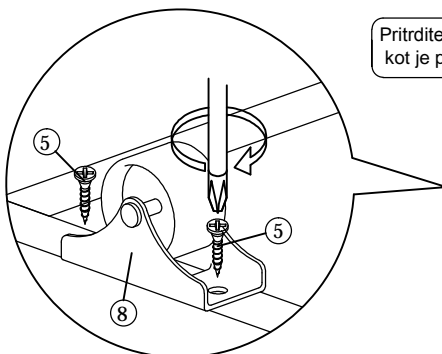

Pritrdite kolesčke z vijaki
kot je prikazano na sliki

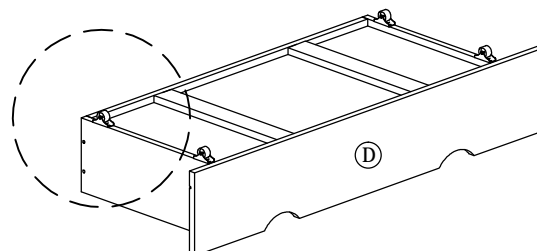

Assembly Instruction

Korak 9

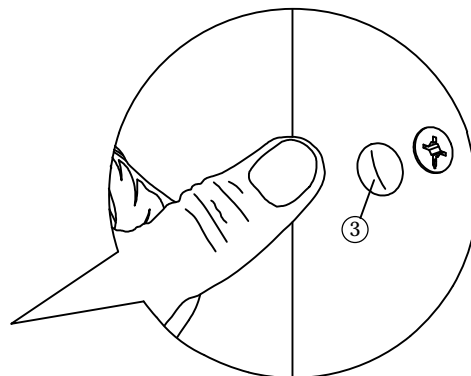
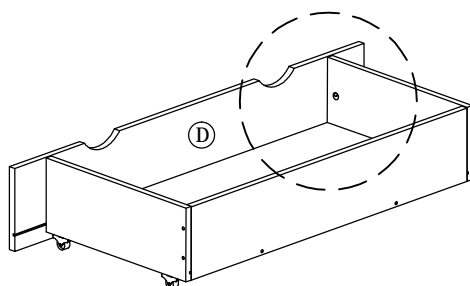

Namestite čepe
zatičnega vijaka

Korak 10

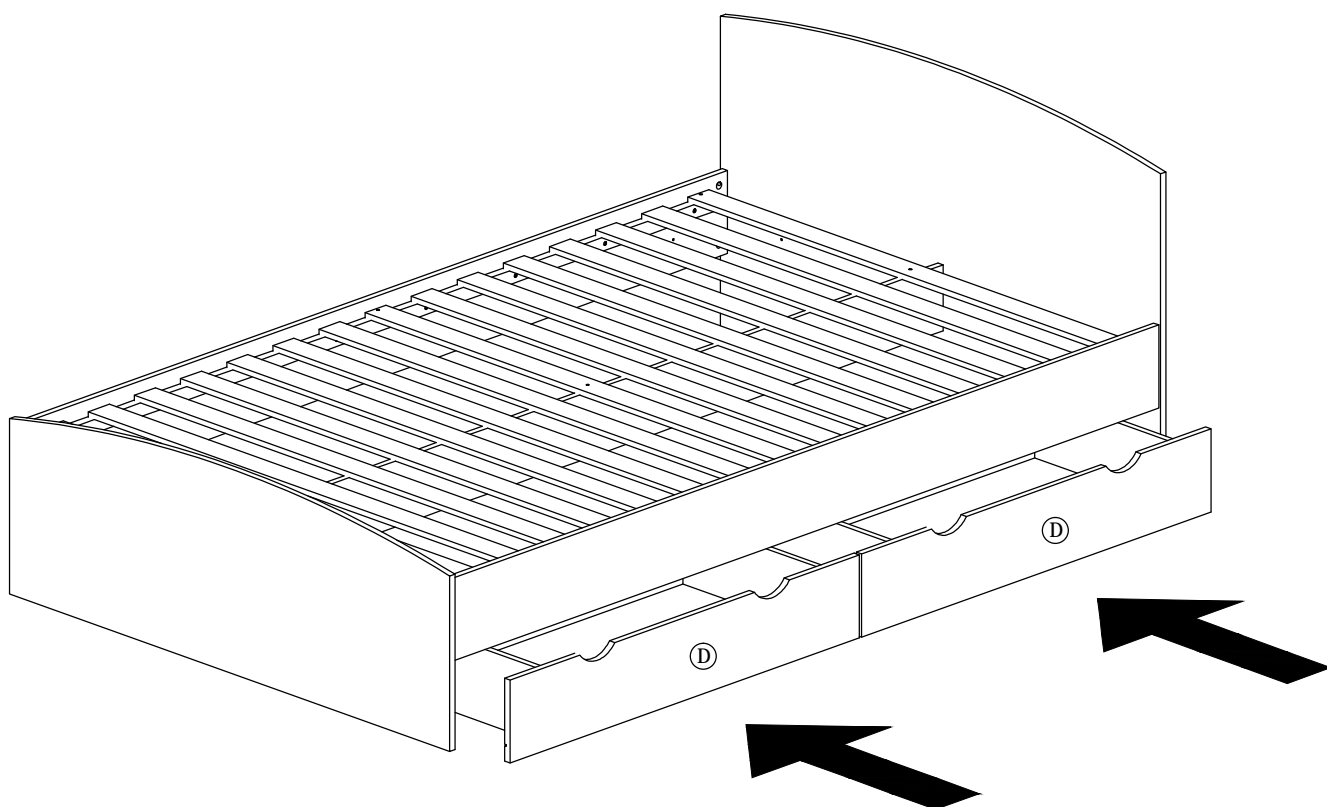

Vstavite predale kot je prikazano