

# RTV 140

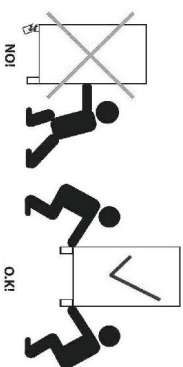

23.05.2016

- (D) Montageanleitung
- (FR) Notice de montage
- (NL) Handleiding voor de montage
- (CZ) Montážní návod
- (HU) Szerelési útmutató
- (TR) Montaj talimatı
- (GB) Assembly Instructions
- (IT) Istruzioni di montaggio
- (PL) Instrukcja montażu
- (SK) Návod na montáž
- (RO) Instrucțiunile de montaj
- (RU) Инструкции по монтажу

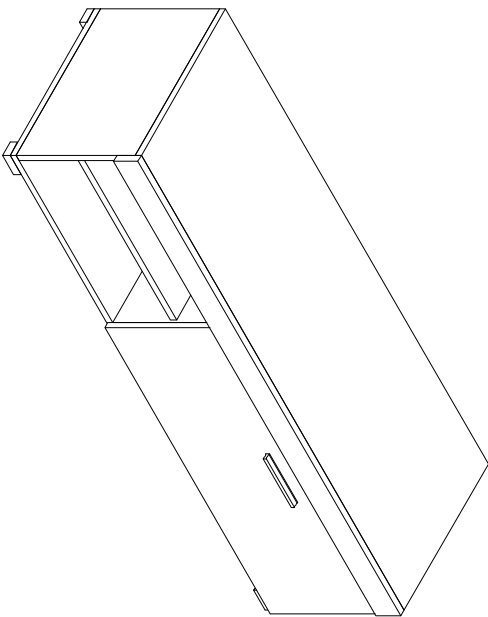
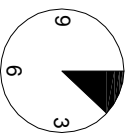
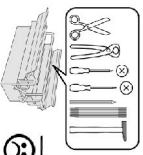

1-1,5

1

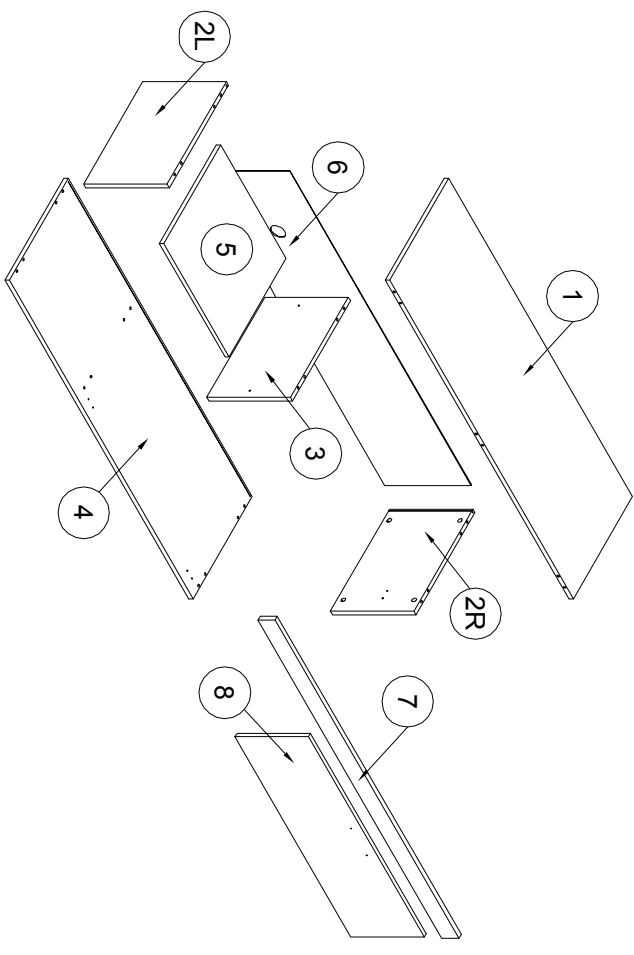

O	X1	ND	X5	H	X4	R	X2	Y	X5	W	X1	YA	X2	N	X2
A	X15	Z	X4	B	X15	NA	X4	P	X2	C	X15	Z	X15	X	X8

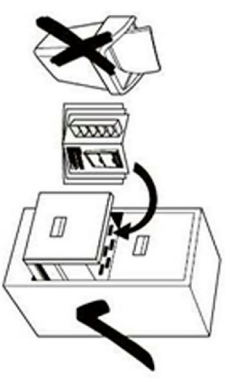
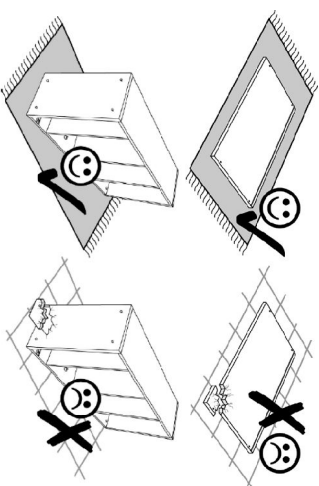

2

3

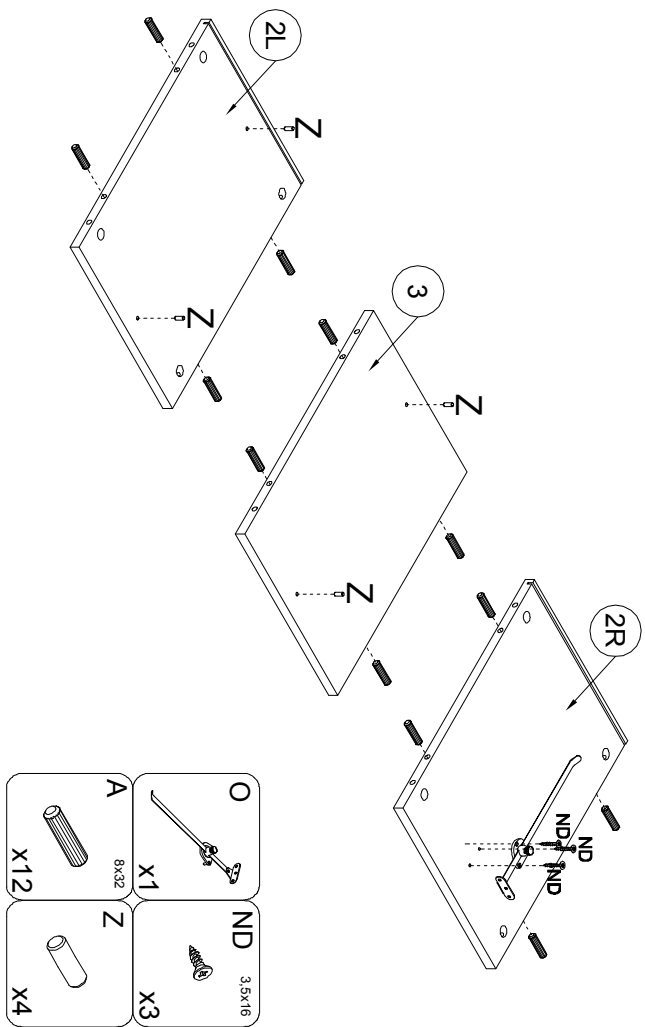

- O** X1
- ND** 3.5x16 X3
- A** 8x32 X12
- Z** X4

5

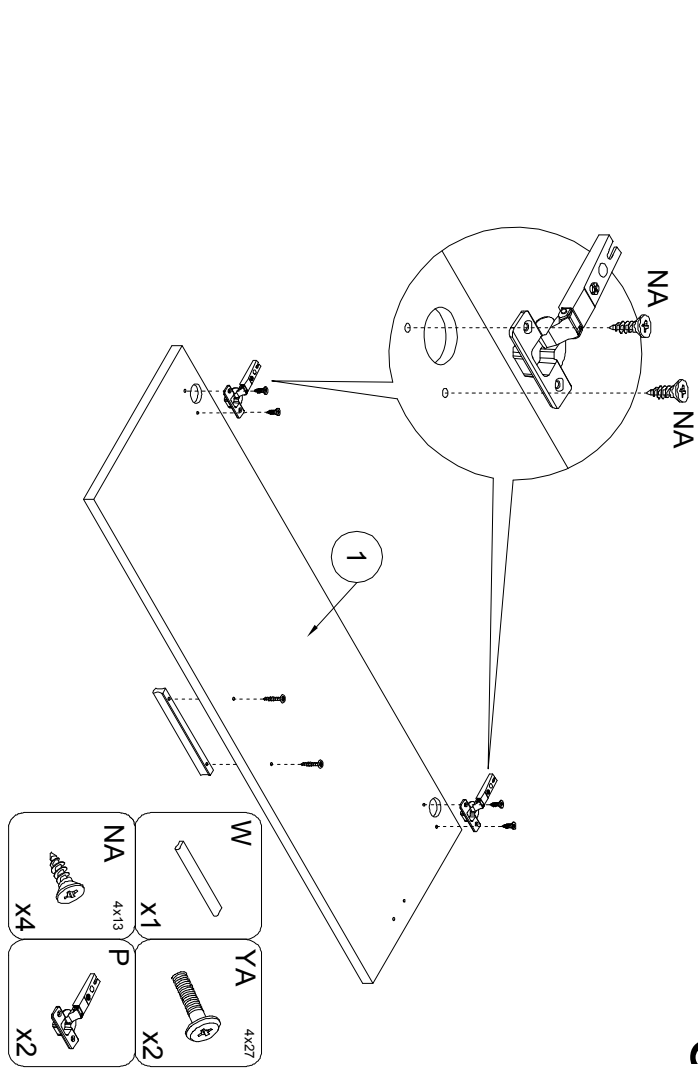

- W** X1
- YA** 4x27 X2
- NA** 4x13 X4
- P** X2

4

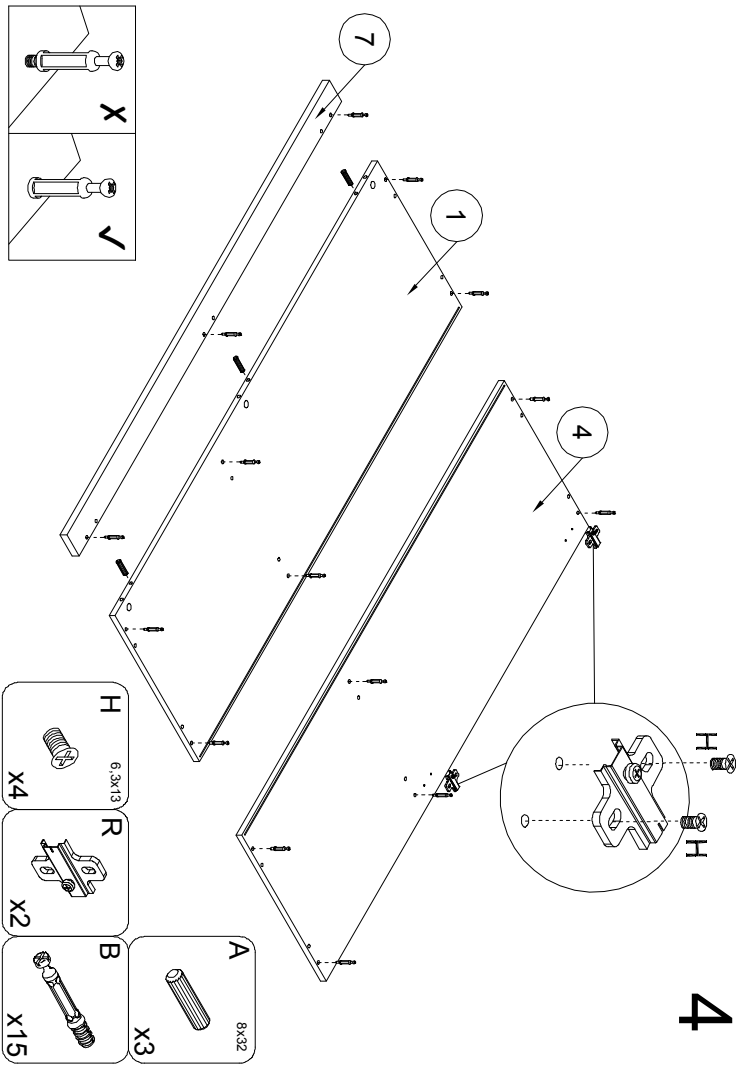

- H** 6.3x13 X4
- R** X2
- A** 8x32 X3
- B** X15

6

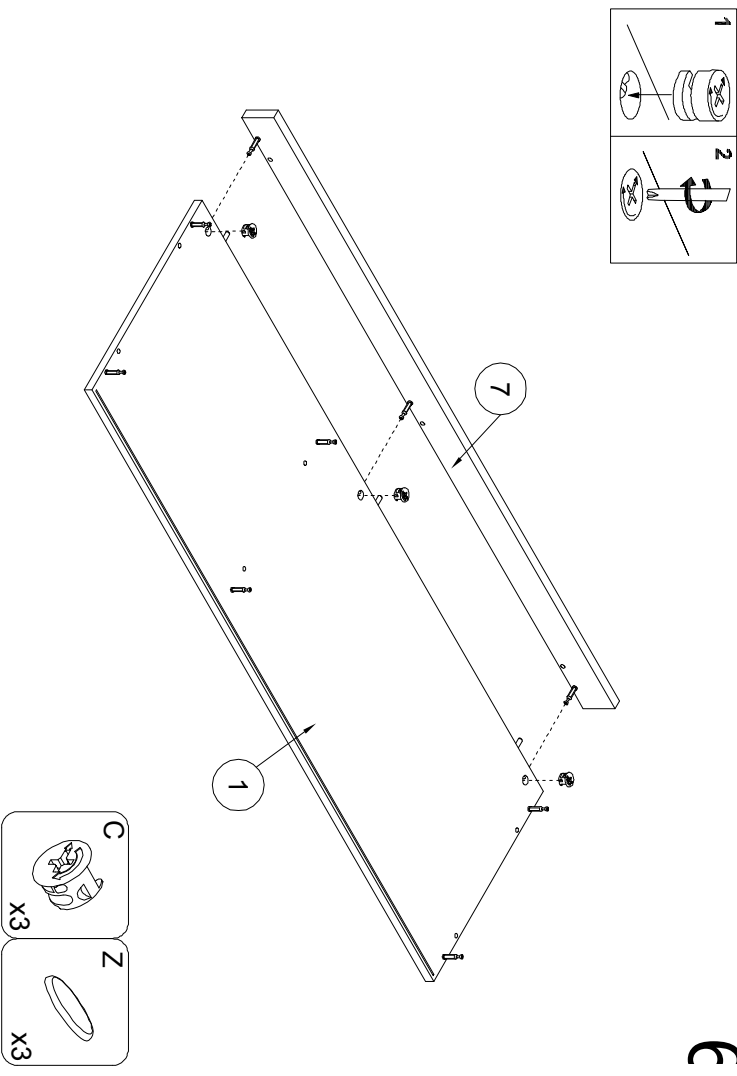

- C** X3
- Z** X3

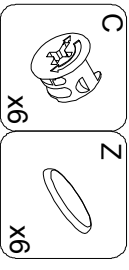
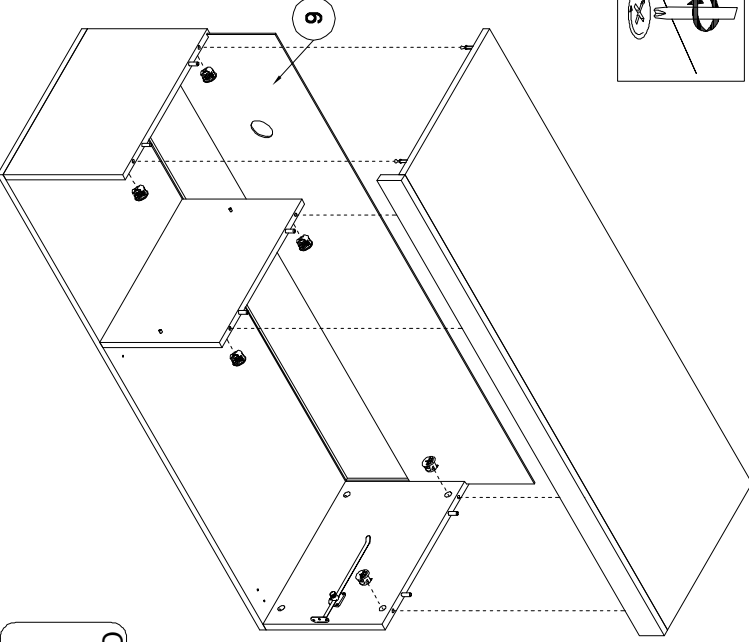
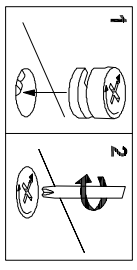
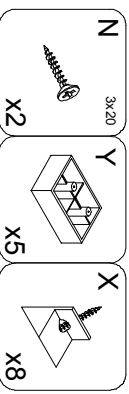
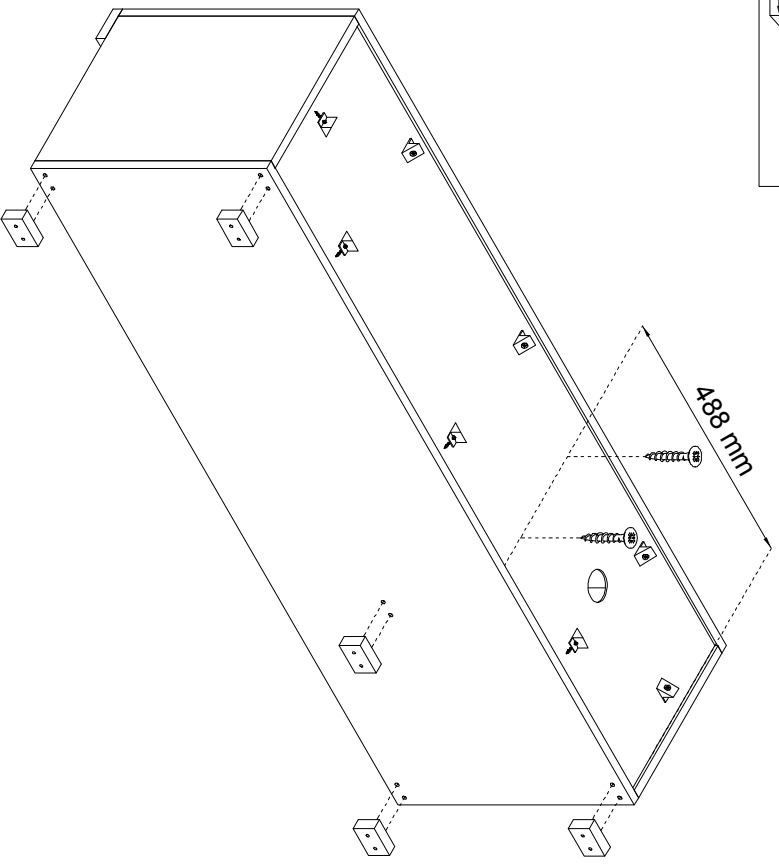
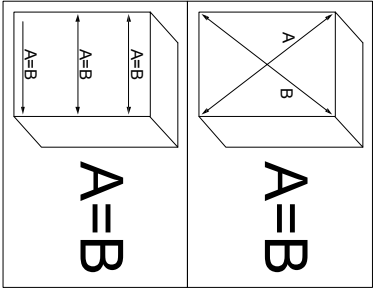
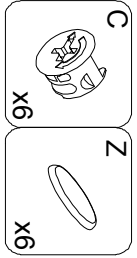
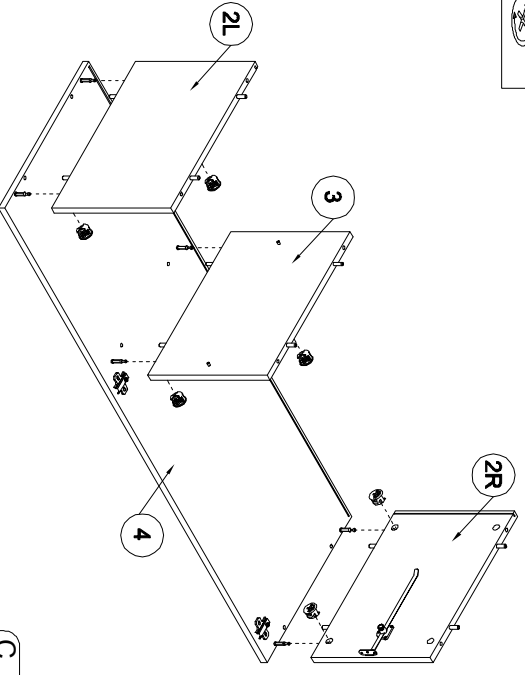
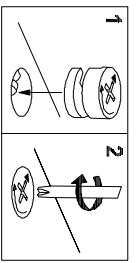

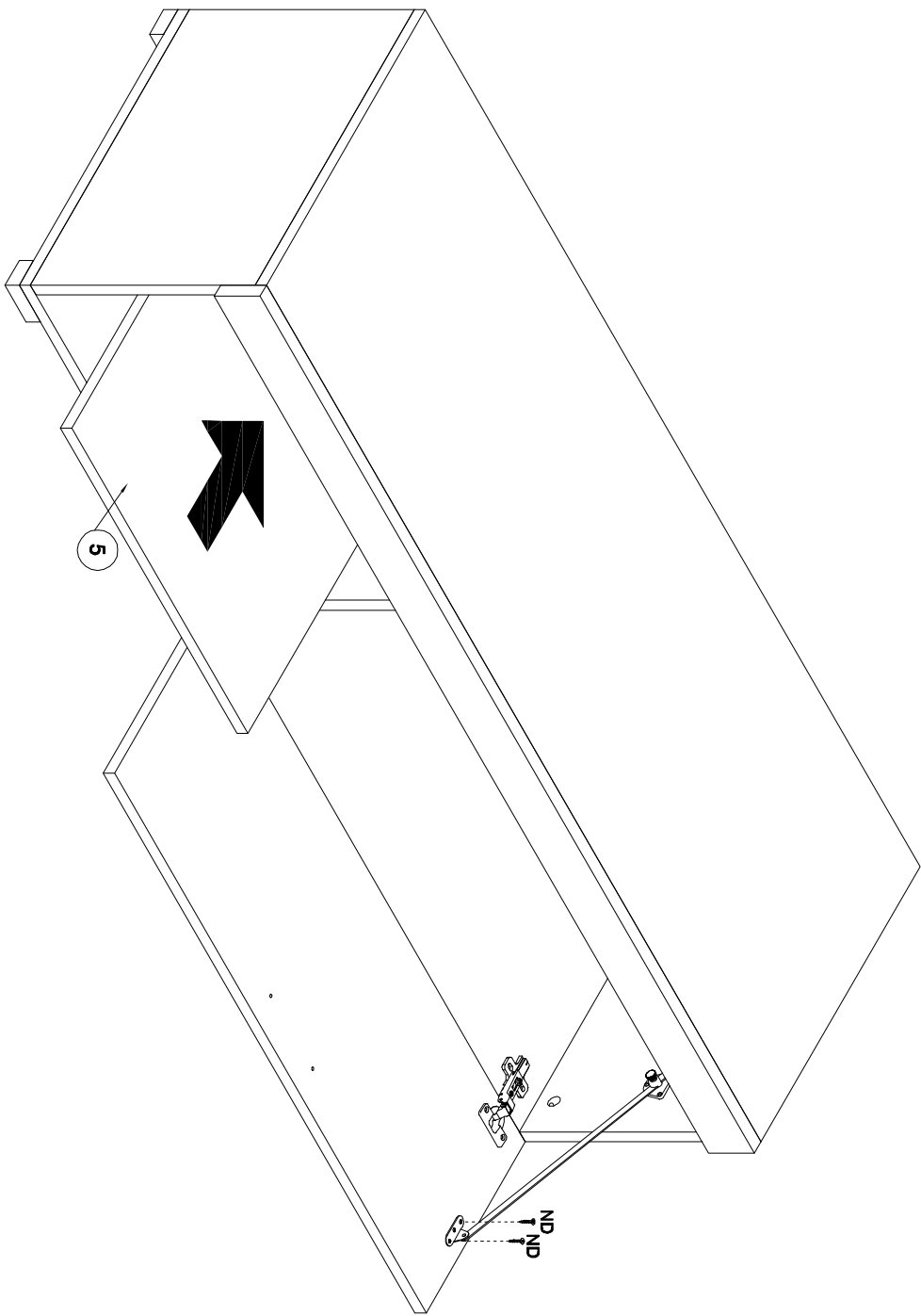

5

ND  
ND

ND  
3.5x16  
X2

