

A	B	C	D
1	F57-1028	2346,	659, 1/2
2	F57-1029	2346,	659, 1/2
3	F57-2040	500	660 2/2
4	F57-2041	500	660 2/2
5	F57-3056	462	658 2/2
6	F57-3057	462	638 2/2
7	F57-9313	1732	471 1/2
8	F57-9315	616	471 1/2
9	g47\25	458,	0 2/2

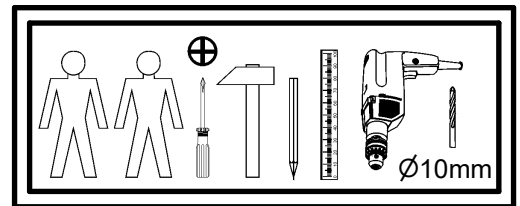

4x K0: Ø35 a204	4x Ø2 b90	4x d20	6x Ø6x13 mm e3	4x Ø6,3x10 mm e50	8x Ø8x30 mm f1	2x g46	4x 32 mm k75\3	12x l2
8x Ø3,5x15 mm p51	12x Ø15x12 mm #16 r1	8x Ø20x12 mm #16 r36	8x 6,7/7,8 r37	12x 20/11 r42	4x Ø12xM10x17mm r66	12x Ø16 s2	4x Ø12x4 mm s41	1x 4 mm z15
1x 3 mm z22					1x 88x21x15/1,5 n14\2	2x Ø3,5x16 mm p38	1x Ø5x60 mm p17	1x Ø10x50 mm f35

1 §2

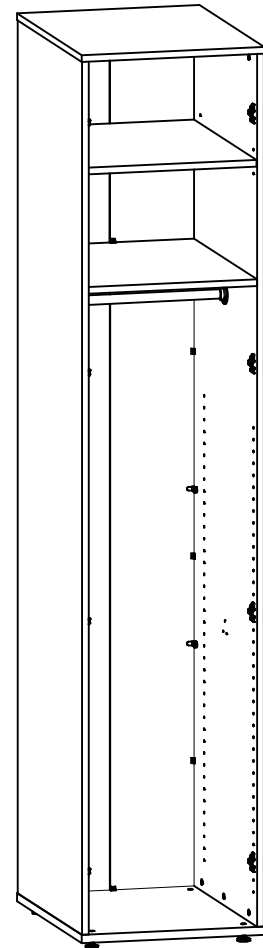
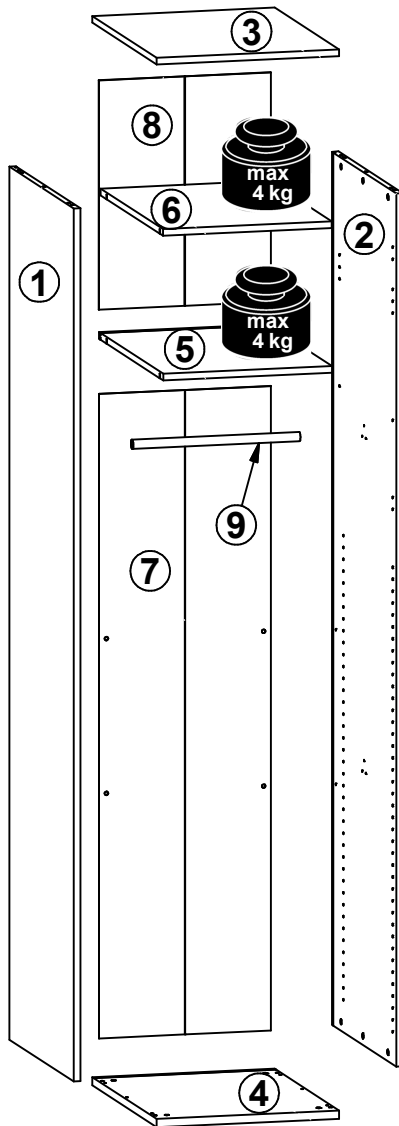
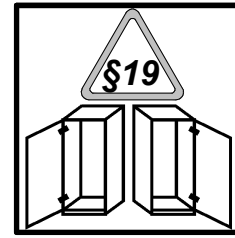
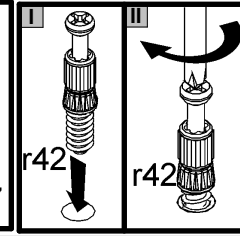
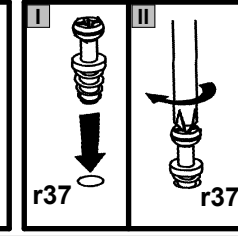
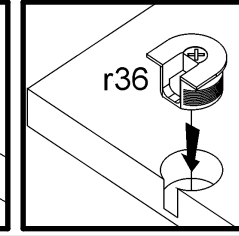
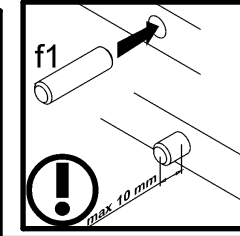
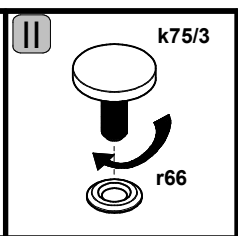
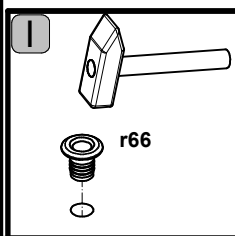
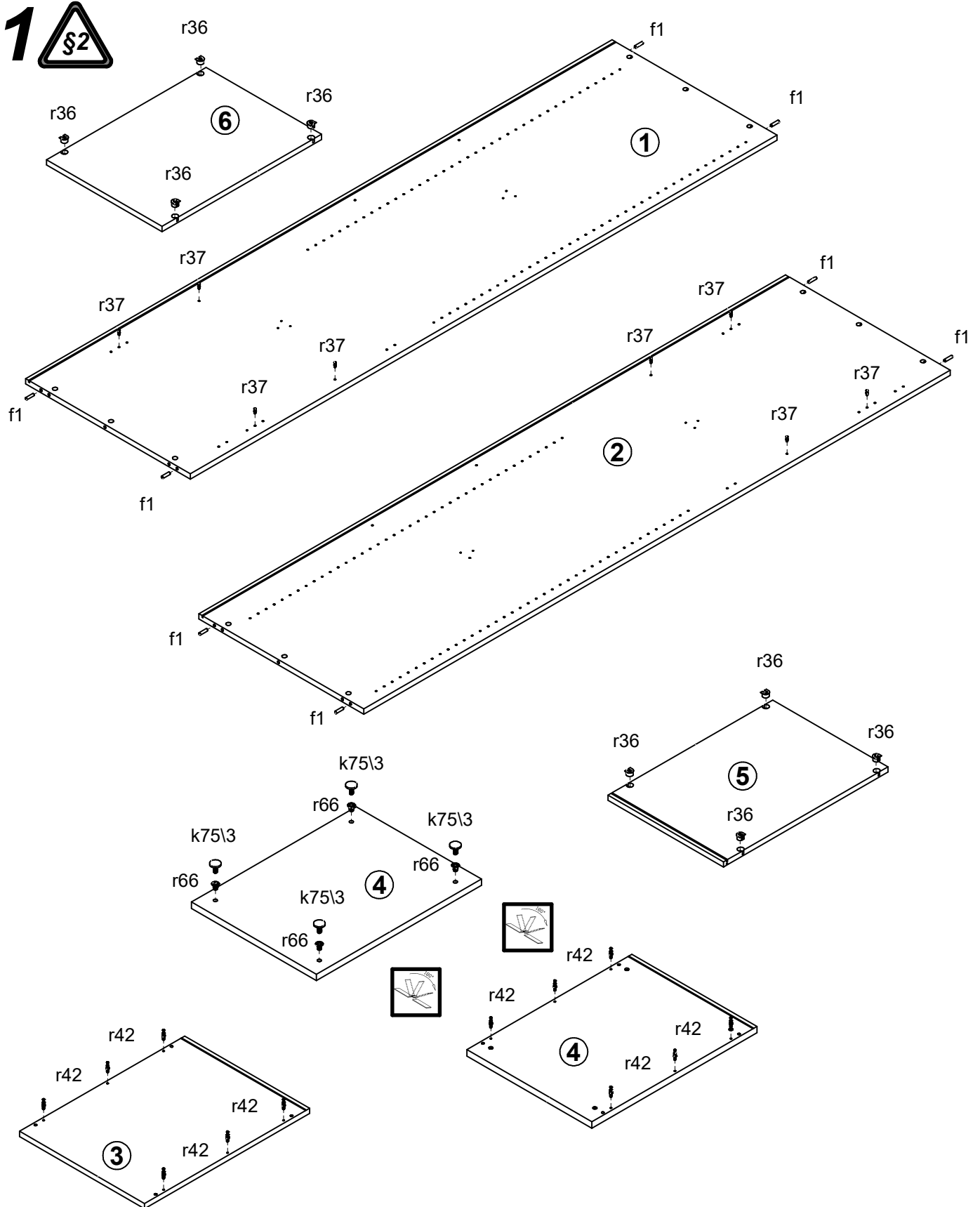

2

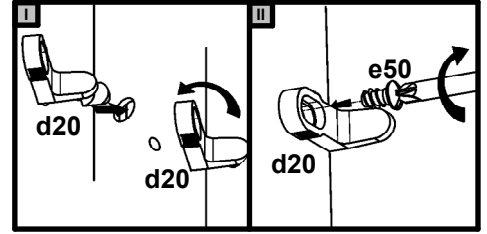

I

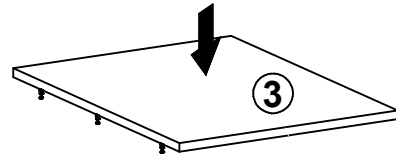
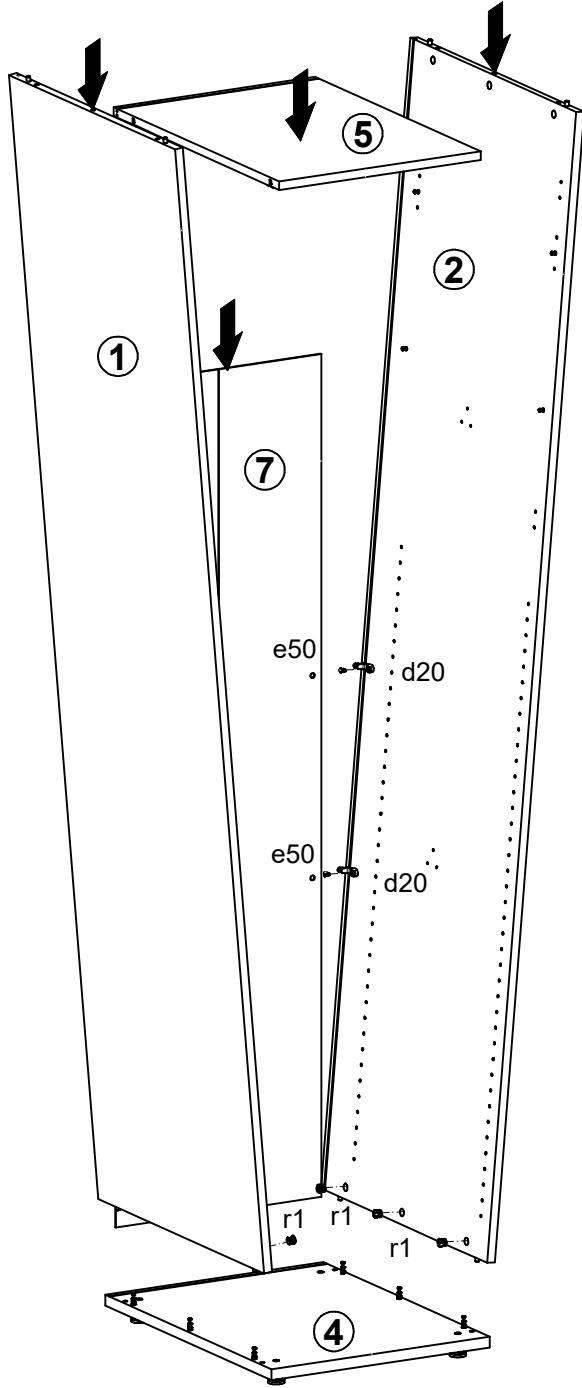

II

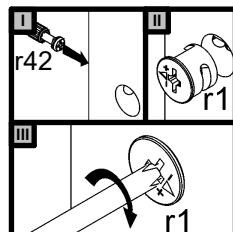
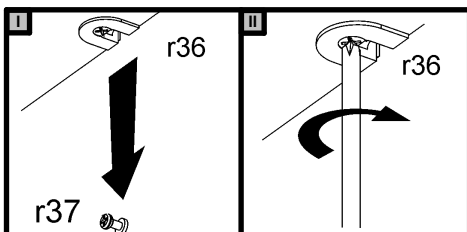
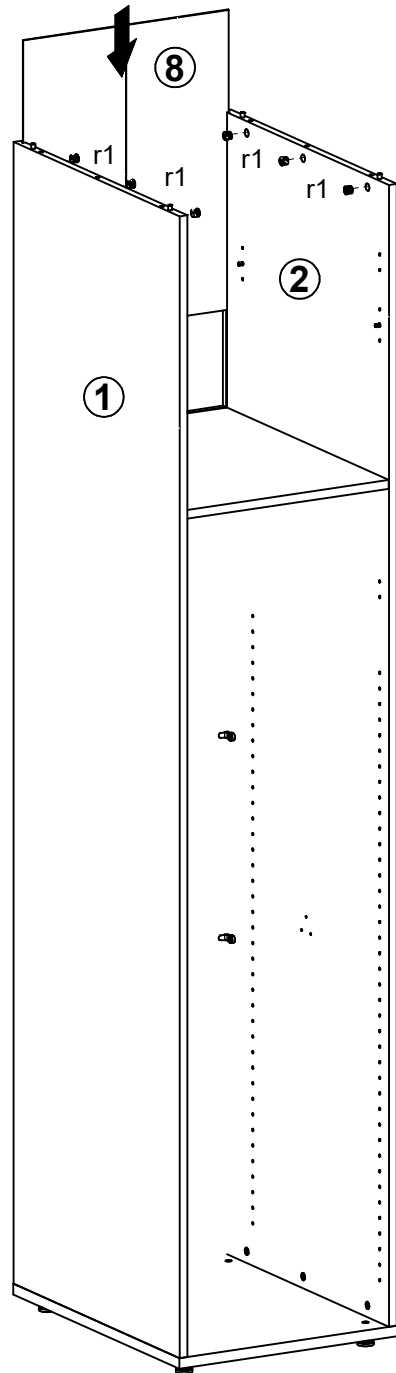

3 §6

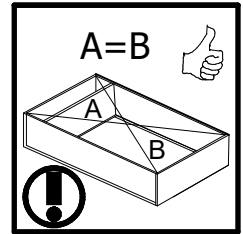
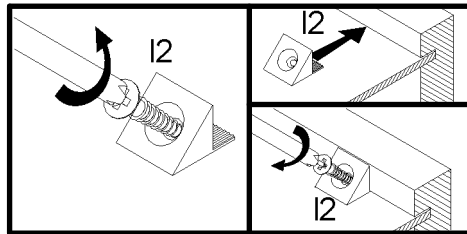

I

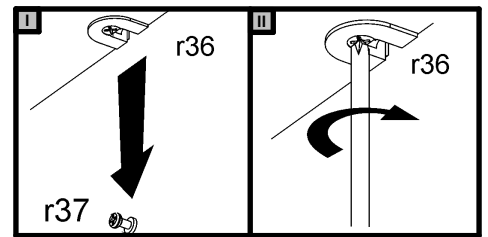
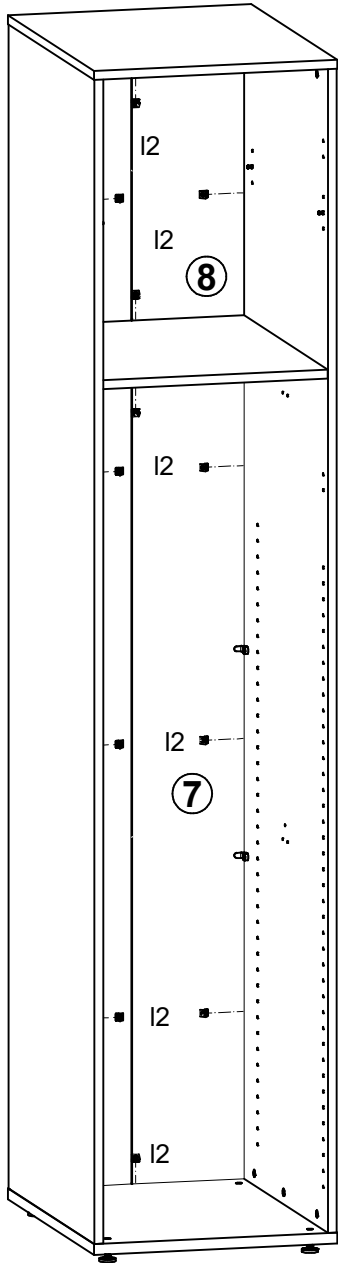

II

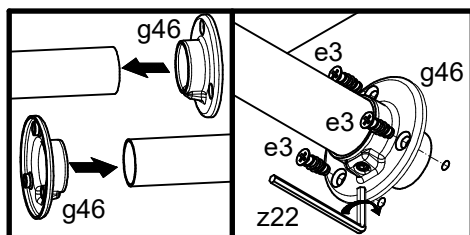
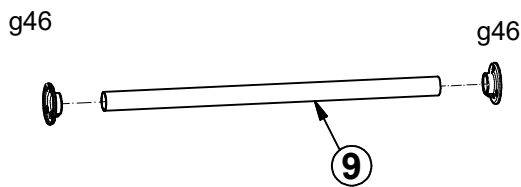
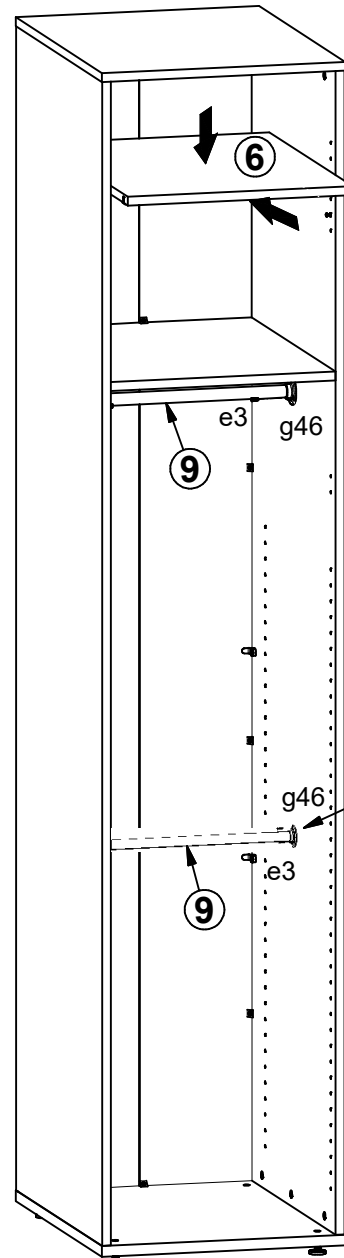

§14

4A

4B

