

A	B	C	D	
1	F57-1034	2346	449	1/2
2	F57-1035	2346	449	1/2
3	F57-1038	2346	449	1/2
4	F57-2046	1000	450	2/2
5	F57-2047	1000	450	2/2
6	F57-3063	462	448	2/2
7	F57-3064	462	428	2/2
8	F57-3073	482	448	2/2
9	F57-3074	482	428	2/2
10	F57-9311	1732	491	1/2
11	F57-9313	1732	471	1/2
12	F57-9314	616	491	1/2
13	F57-9315	616	471	1/2

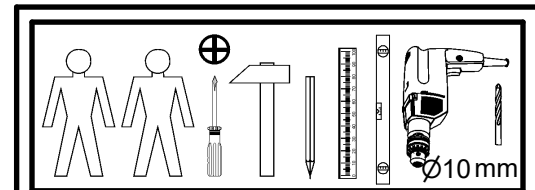

8x K0: g35 a204	8x b2 b90	8x d20	8x e50 Ø6,3x10 mm	12x f1 Ø8x30 mm	2x L-360x60 g76/2	4x M4x25 mm j53	6x k75/3 32 mm	20x l2
16x Ø3,5x15 mm p51	12x Ø15x12 mm #16 r1	16x Ø20x12 mm #16 r36	16x 6,7/7,8 r37	12x 20/11 r42	6x Ø12xM10x17mm r66	12x Ø16 s2	4x Ø5 s4	4x Ø8 s6
6x Ø12x4 mm s41	1x 4 mm z15				2x 88x21x15/1,5 n14/2	4x Ø3,5x16 mm p38	2x Ø5x60 mm p17	2x Ø10x50 mm f35

1 

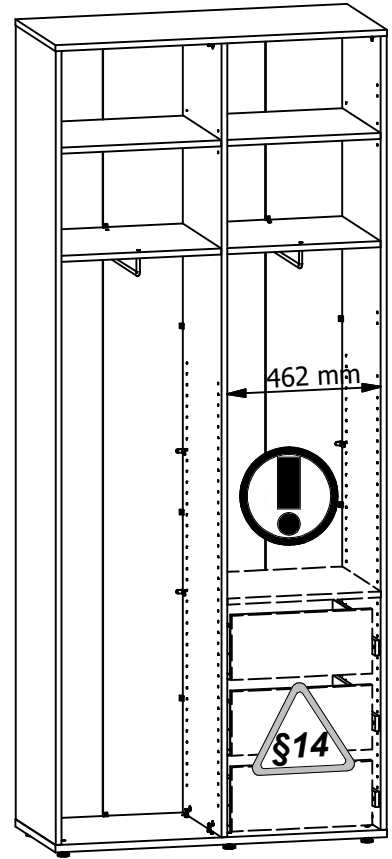
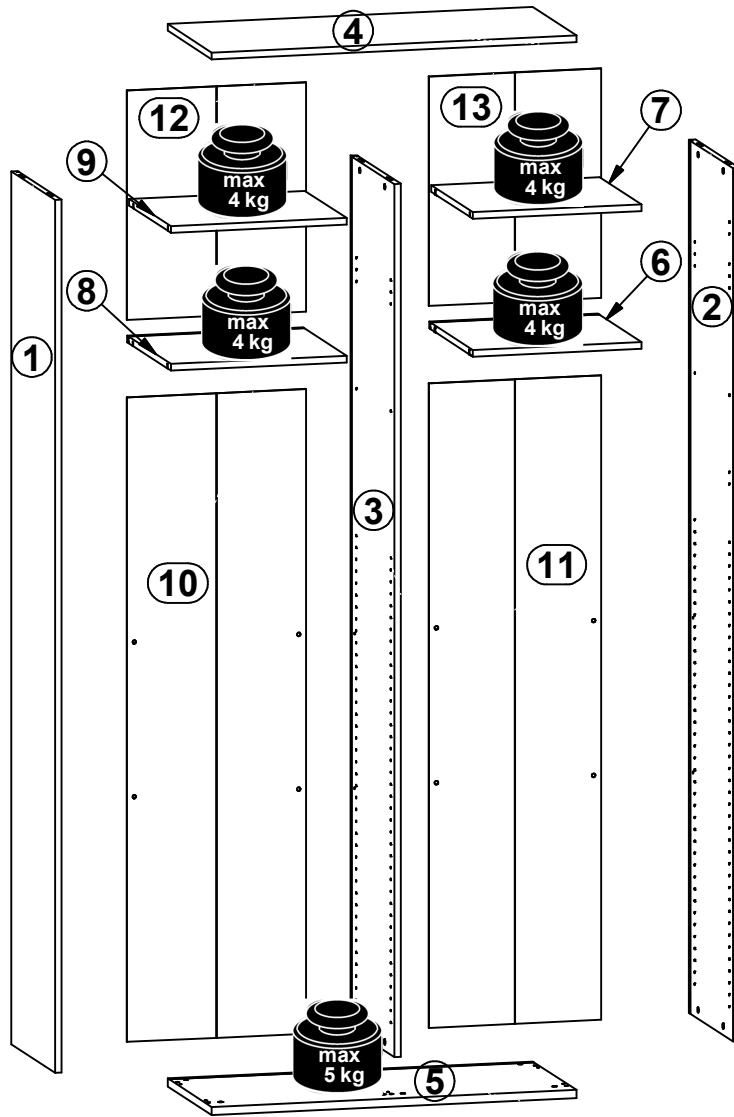
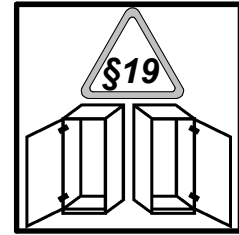
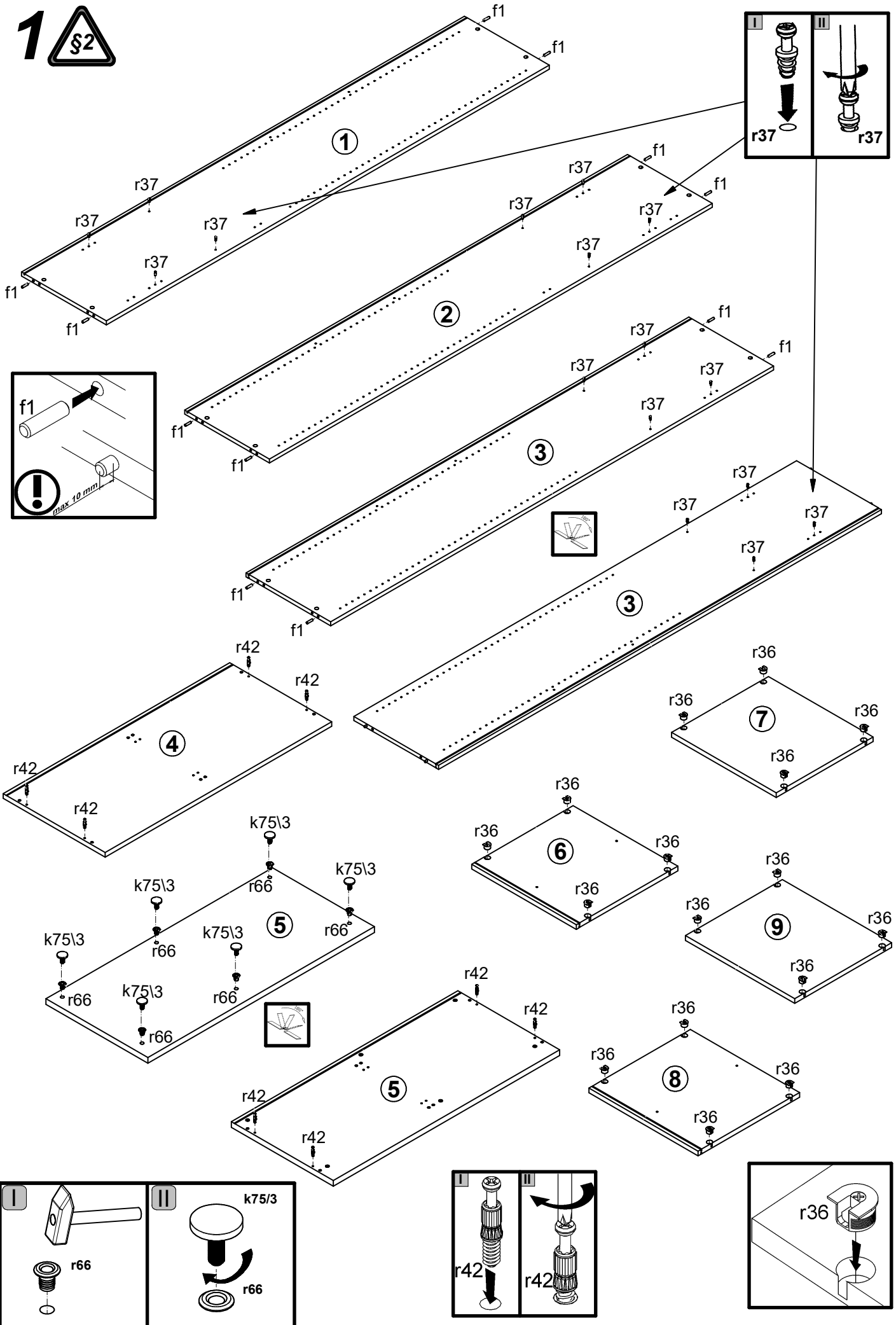

2A

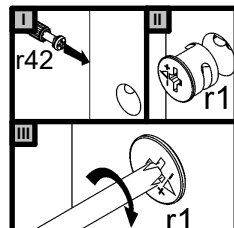
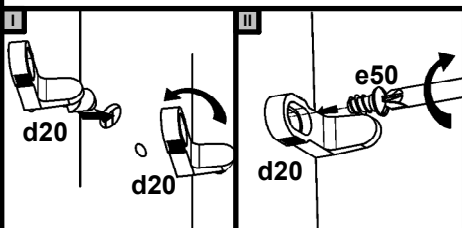
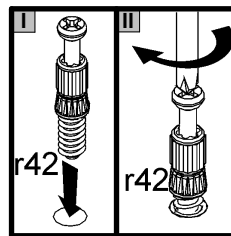
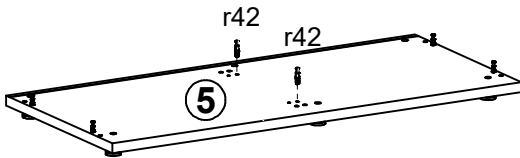
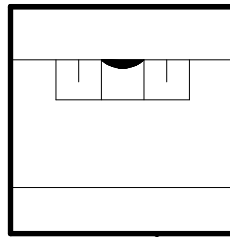
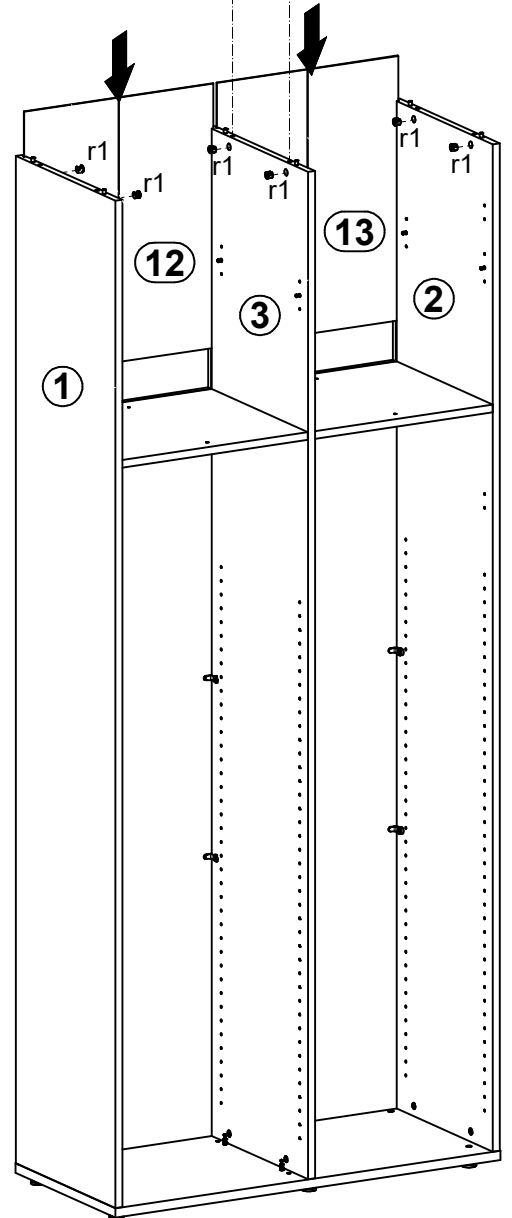
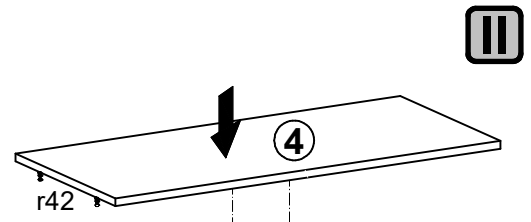
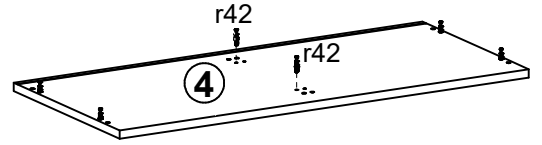
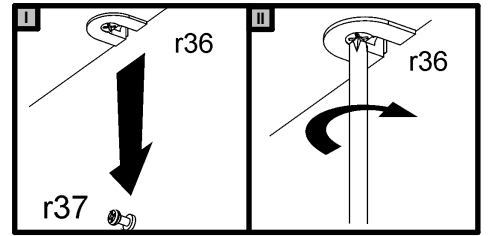
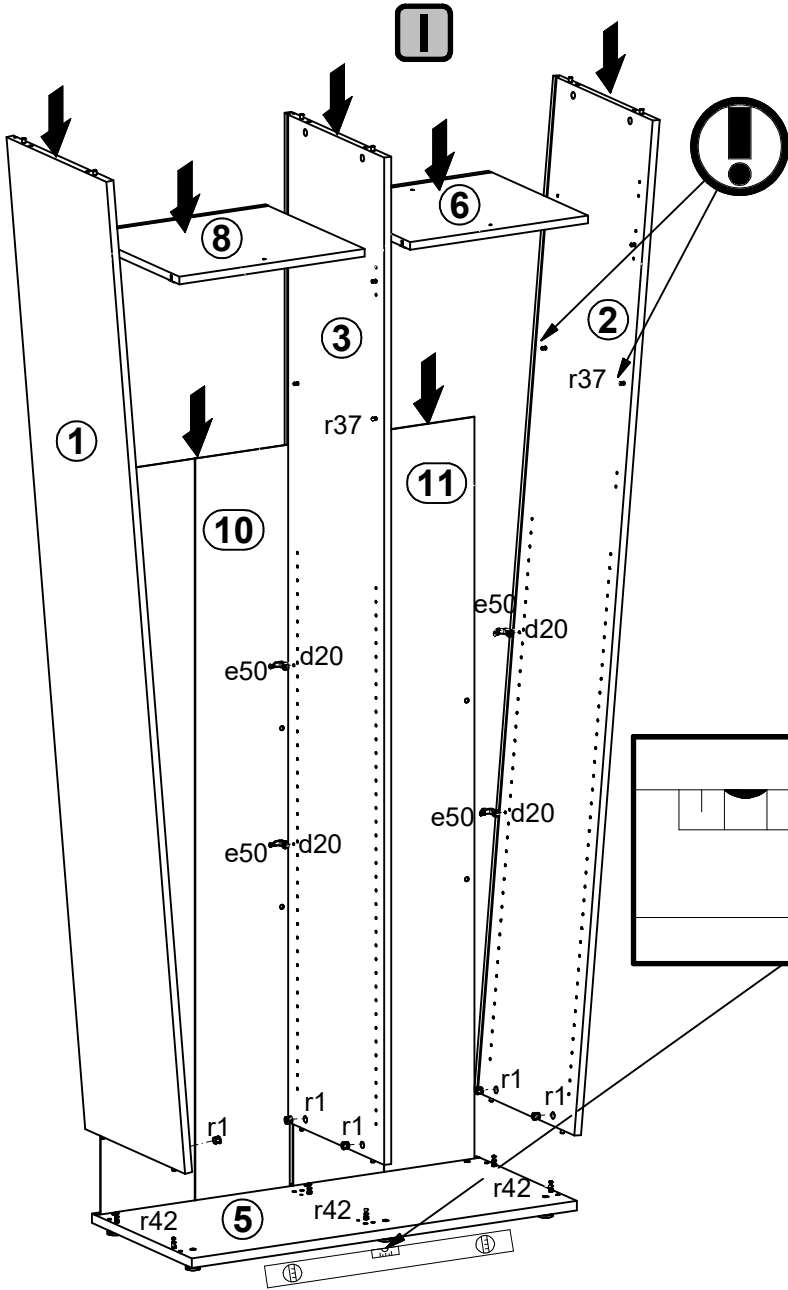

3A



I

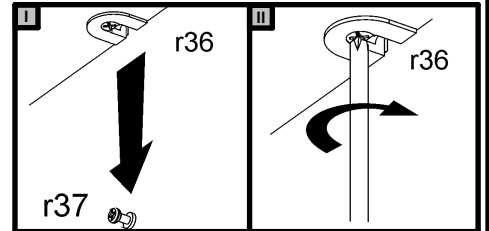
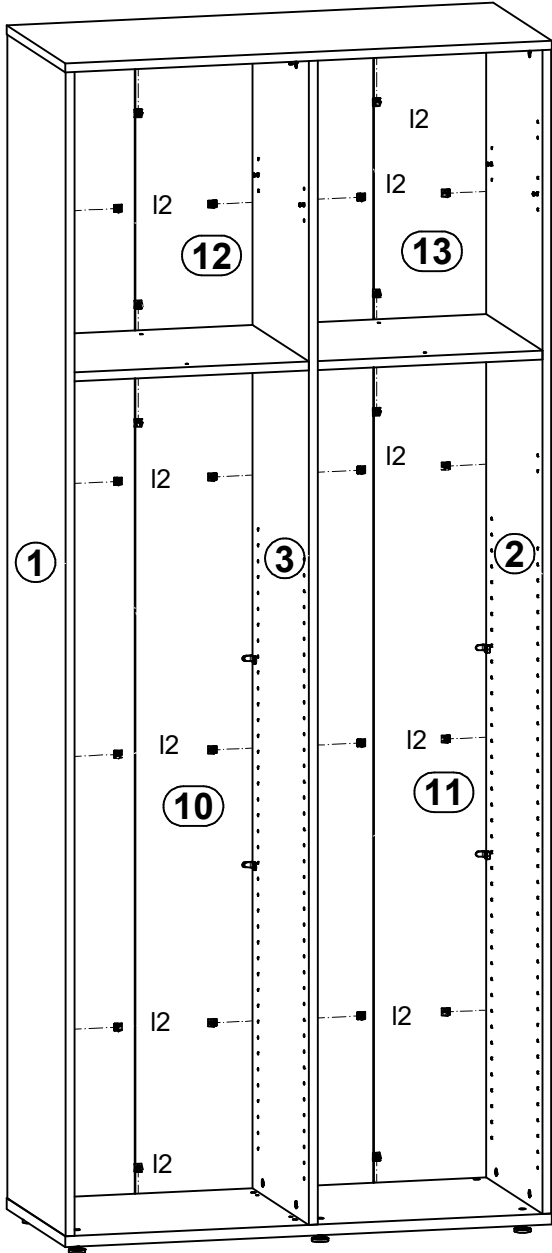
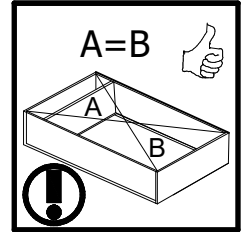
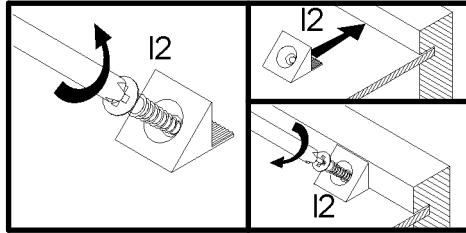

II

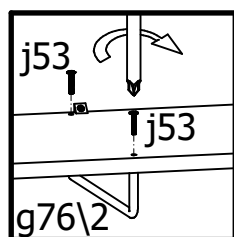
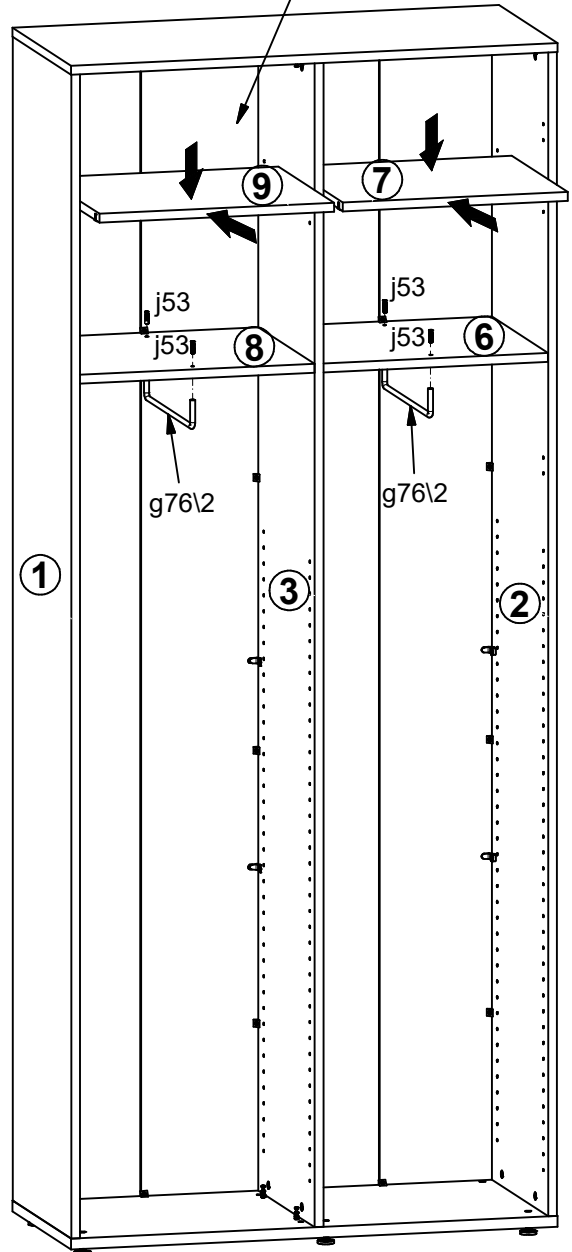

2B



I

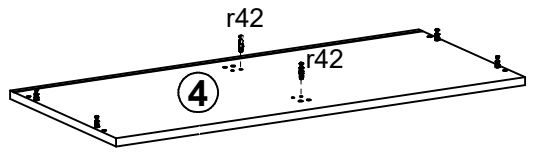
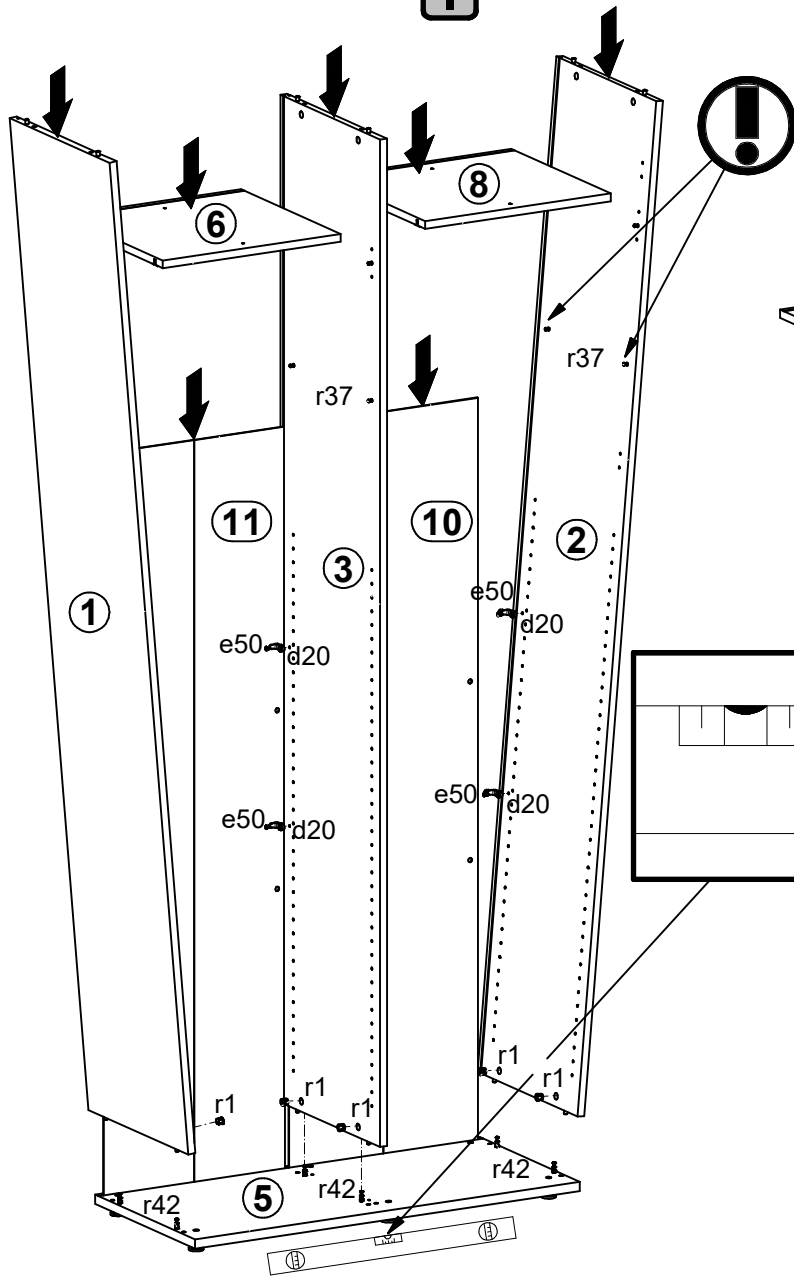
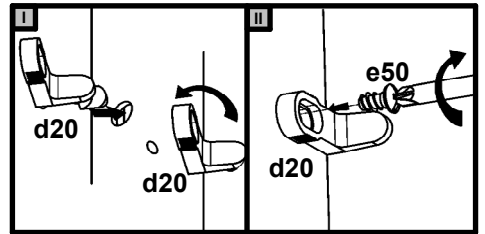

II

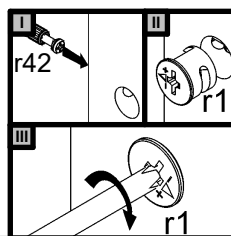
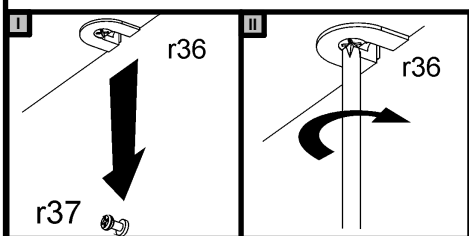
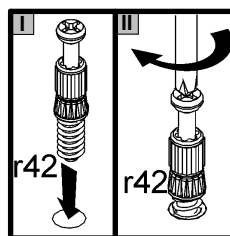
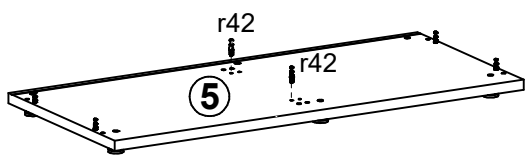
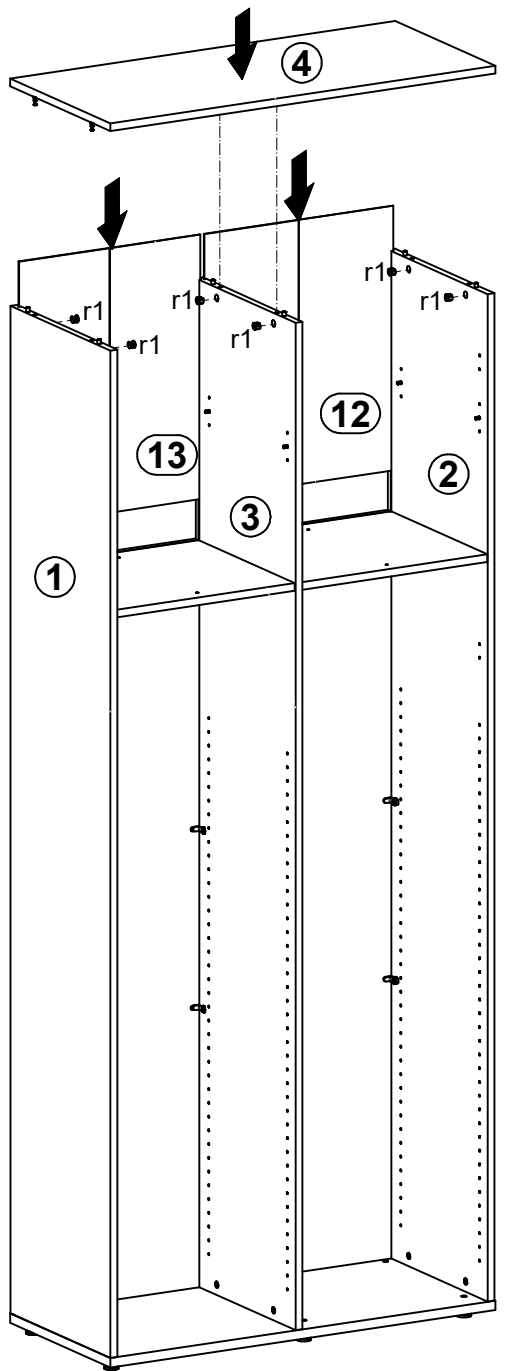

3B



I

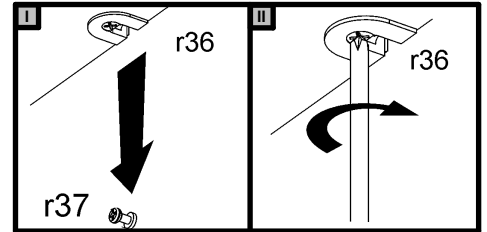
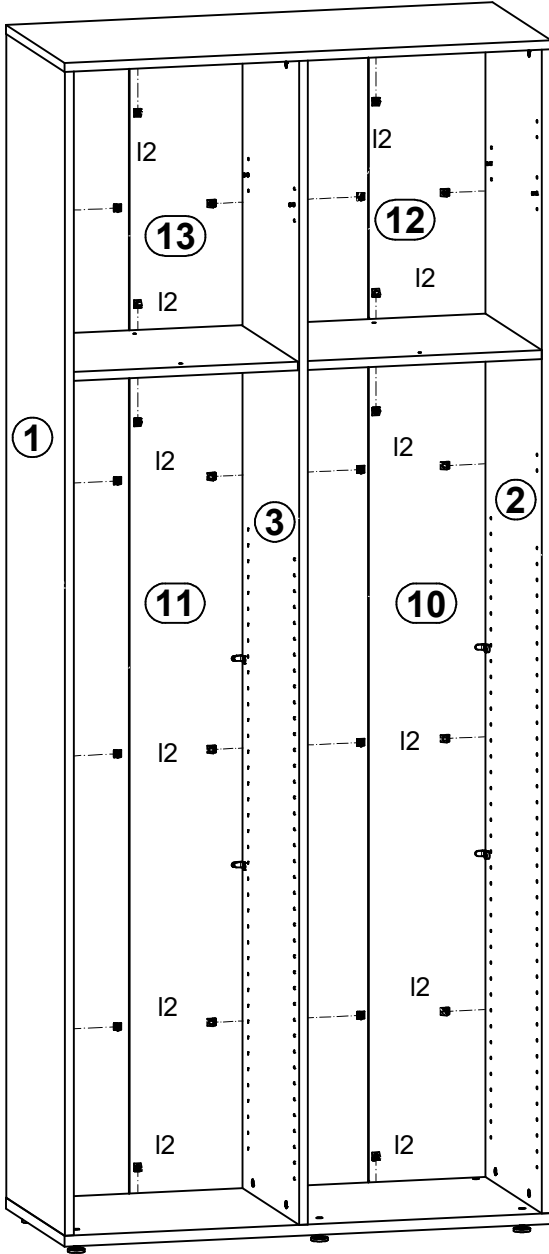
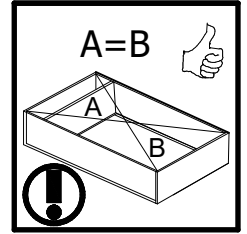
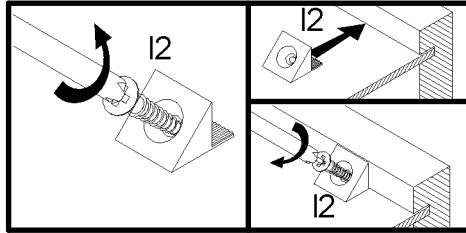

II

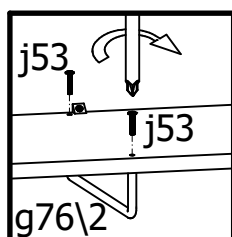
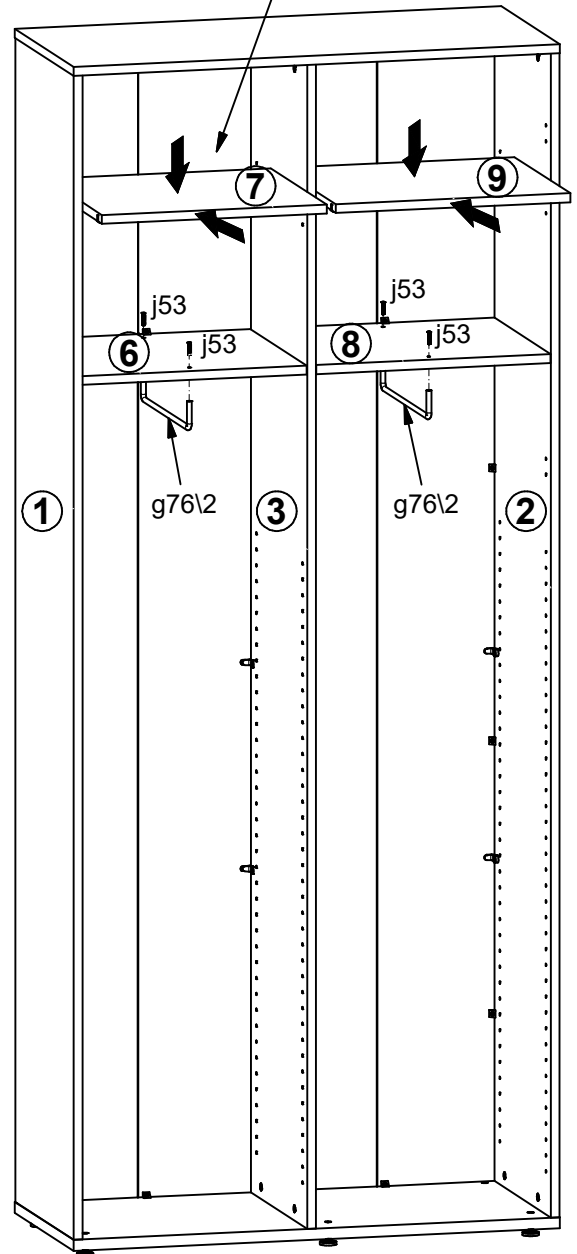

4 §6

