

A	B	C			D
1	B23-0002	18,9 in	4,4 in	0,6 in	1/1
2	B23-0003	18,9 in	4,4 in	0,6 in	1/1
3	B23-1004	29,0 in	23,1 in	0,6 in	1/1
4	B23-1005	29,0 in	23,1 in	0,6 in	1/1
5	B23-1006	4,2 in	21,1 in	0,6 in	1/1
6	B23-2002	39,4 in	23,2 in	0,7 in	1/1
7	B23-4002	38,1 in	14,2 in	0,6 in	1/1
8	B23-4003	38,1 in	5,9 in	0,6 in	1/1
9	B23-5003	15,7 in	3,0 in	0,5 in	1/1
10	B23-5004	15,7 in	3,0 in	0,5 in	1/1
11	B23-9002	17,7 in	16,0 in	0,1 in	1/1
12	ZS7-5012	16,8 in	3,0 in	0,6 in	1/1

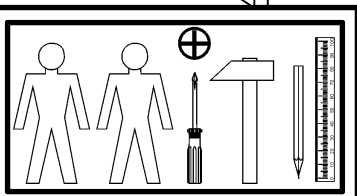

2x 5,04 in c310	2x Ø0,28x1,97 in e1	6x Ø0,24x0,51 in e3	8x Ø0,20x0,35 in e19	11x Ø0,31x1,18 in f1	8x Ø0,26x1,57 in f25	4x k1	6x Ø0,14x0,63 in p38	2x Ø0,12x0,47 in p54
4x Ø0,16x0,98 in p87	15x Ø0,59x0,47 in r80	23x Ø0,20x0,94 in r82	8x Ø0,59x0,39 in r84	2x 15,75 in w5\CL	2x 15,75 in w5\CR	2x 15,75 in w5\DL	2x 15,75 in w5\DR	2x Ø0,63 in s2
1x 0,16 in z40								

A	B	C			D
1	B23-0002	480 mm	112 mm	15 mm	1/1
2	B23-0003	480 mm	112 mm	15 mm	1/1
3	B23-1004	736 mm	588 mm	15 mm	1/1
4	B23-1005	736 mm	588 mm	15 mm	1/1
5	B23-1006	106 mm	537 mm	15 mm	1/1
6	B23-2002	1000 mm	590 mm	18 mm	1/1
7	B23-4002	968 mm	360 mm	15 mm	1/1
8	B23-4003	968 mm	150 mm	15 mm	1/1
9	B23-5003	400 mm	75 mm	12 mm	1/1
10	B23-5004	400 mm	75 mm	12 mm	1/1
11	B23-9002	449 mm	407 mm	3 mm	1/1
12	ZS7-5012	427 mm	75 mm	15 mm	1/1

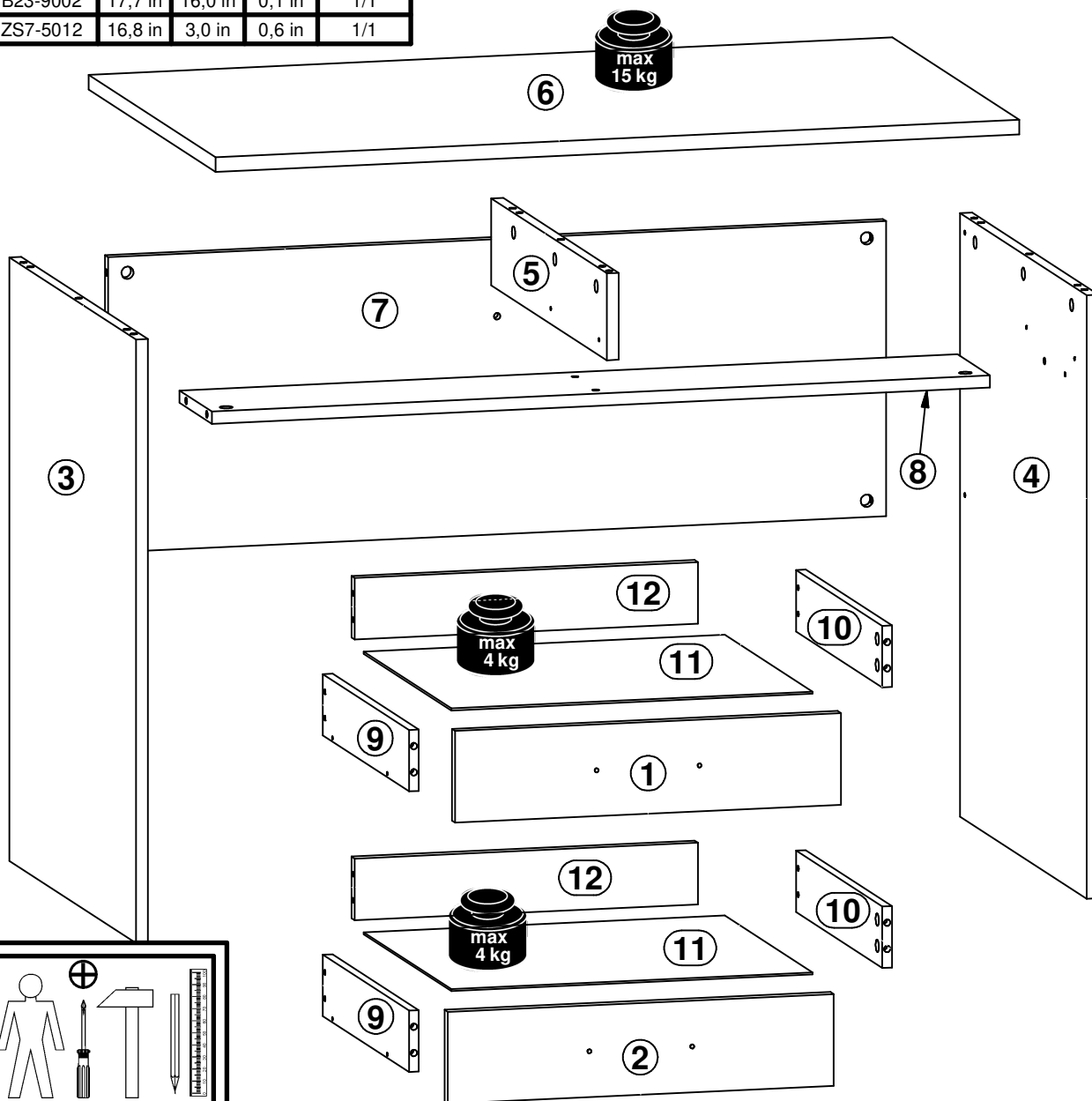
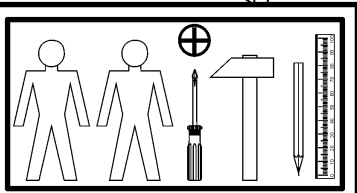
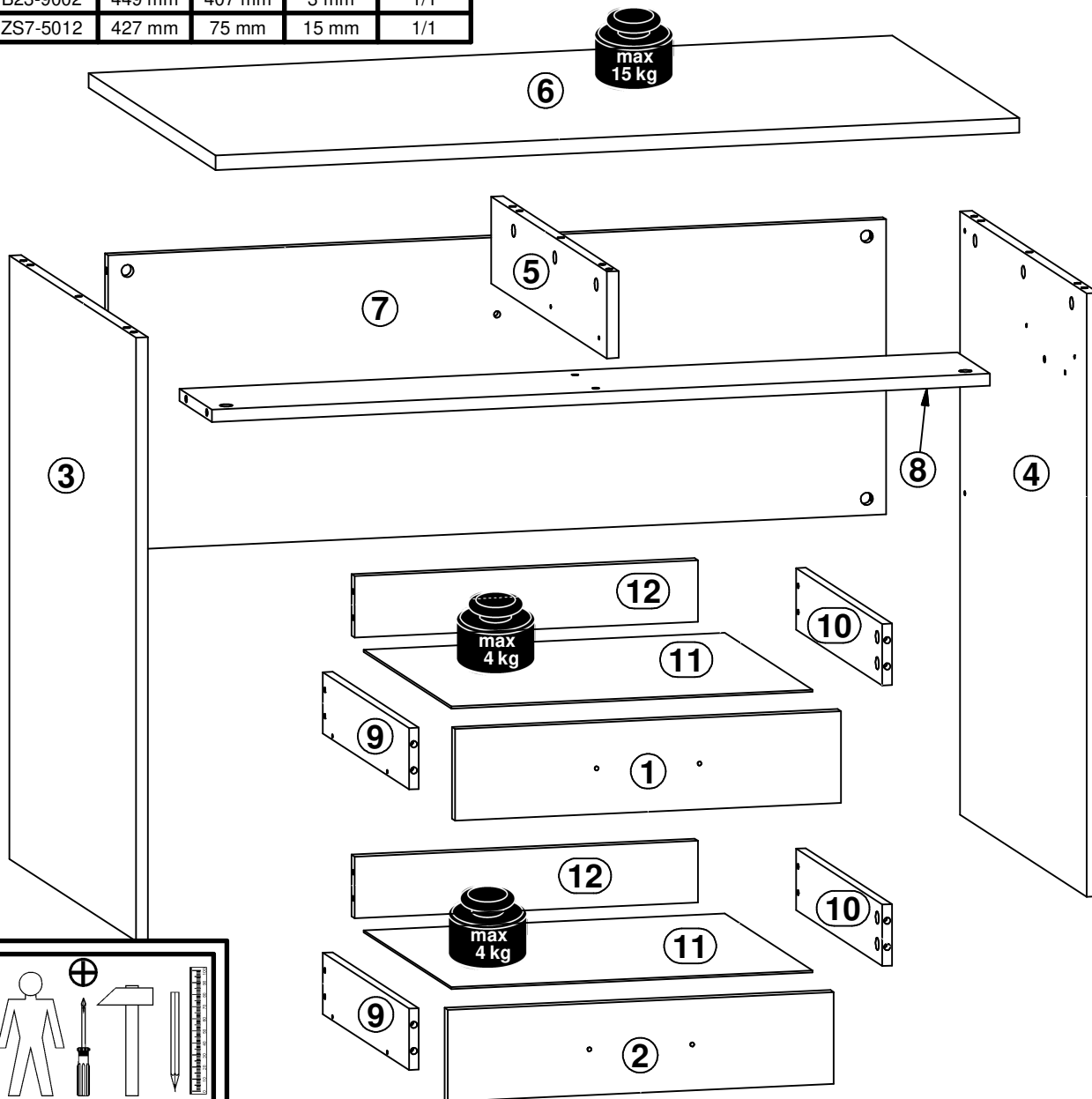

2x 128 mm c310	2x Ø7x50 mm e1	6x Ø6x13 mm e3	8x Ø5x9 mm e19	11x Ø8x30 mm f1	8x Ø6.5x40 mm f25	4x k1	6x Ø3.5x16 mm p38	2x Ø3x12 mm p54
4x Ø4x25 mm p87	15x Ø15x12 mm r80	23x Ø5x24 mm r82	8x Ø15x9.9 mm r84	2x 400 mm w5\CL	2x 400 mm w5\CR	2x 400 mm w5\DL	2x 400 mm w5\DR	2x Ø16 mm s2
1x 4 mm z40								

1

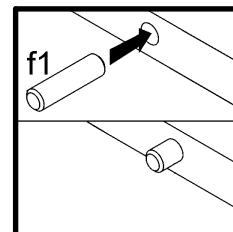
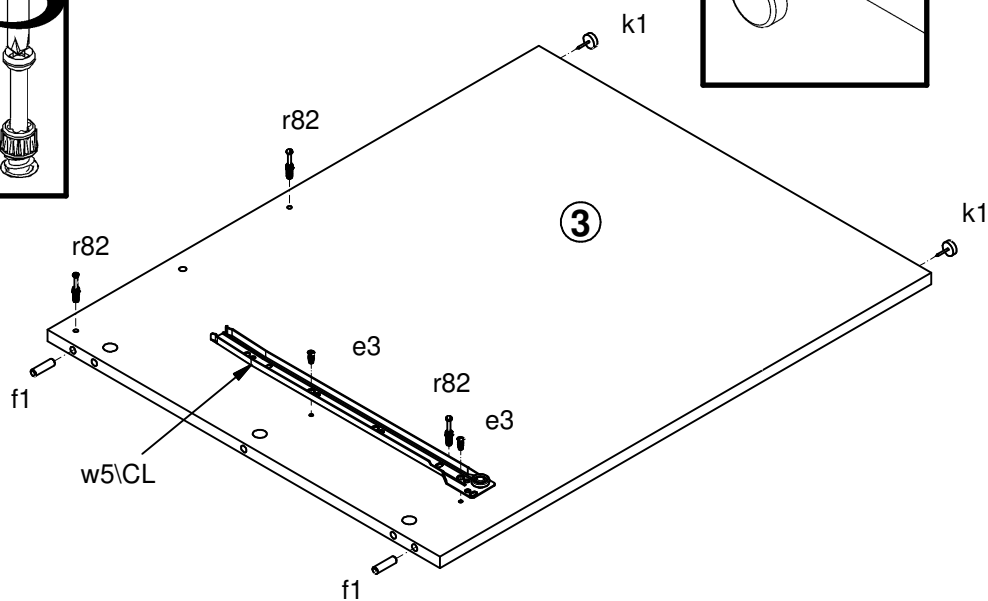
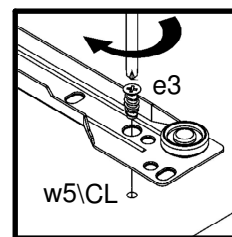
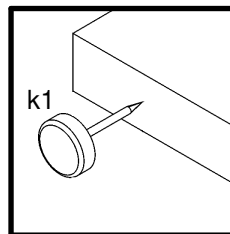
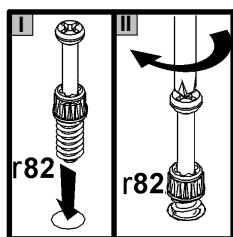

Zamontuj prowadnice w5\CL za pomocą 2 wkrętów e3 do elementu 3.
Zamontuj trzpienie r82 do elementu 3.
Zamontuj ślizgacze k1 do elementu 3.
Zamontuj kołki f1 do elementu 3.

2

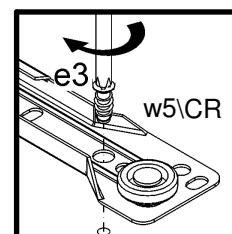
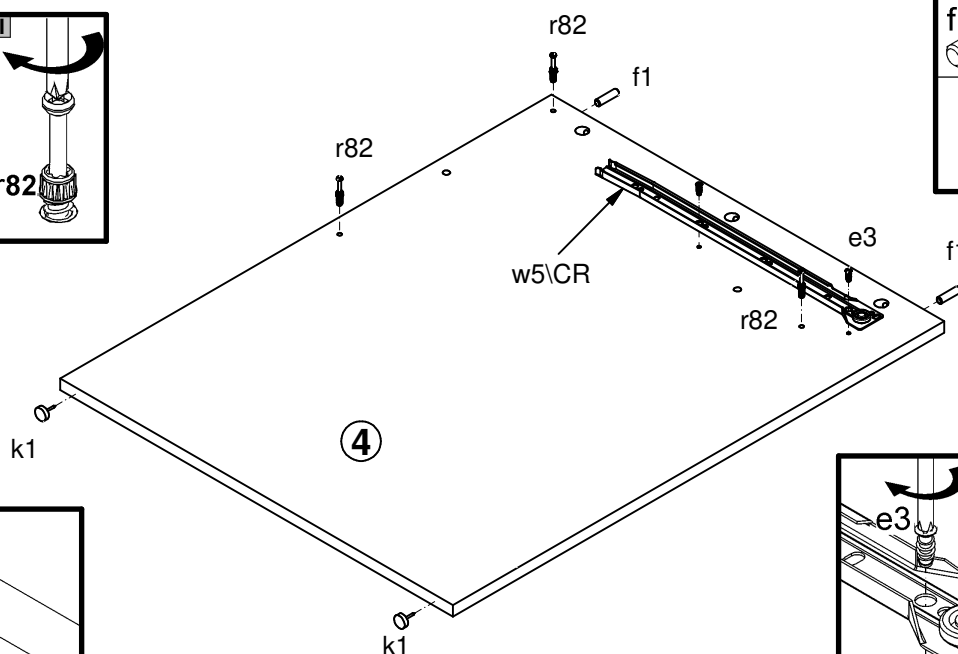
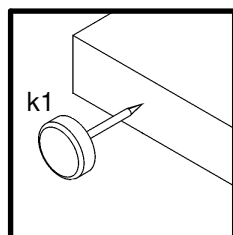
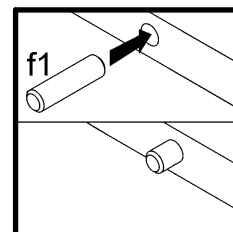
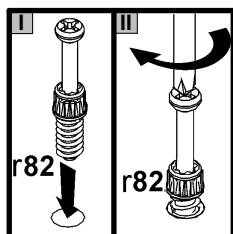

Zamontuj prowadnice w5\CR za pomocą 2 wkrętów e3 do elementu 4.
Zamontuj trzpienie r82 do elementu 4.
Zamontuj ślizgacze k1 do elementu 4.
Zamontuj kołki f1 do elementu 4.

3

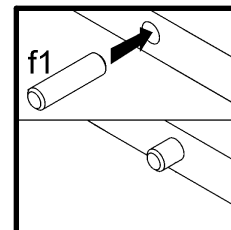
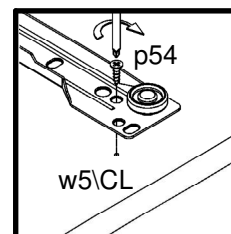
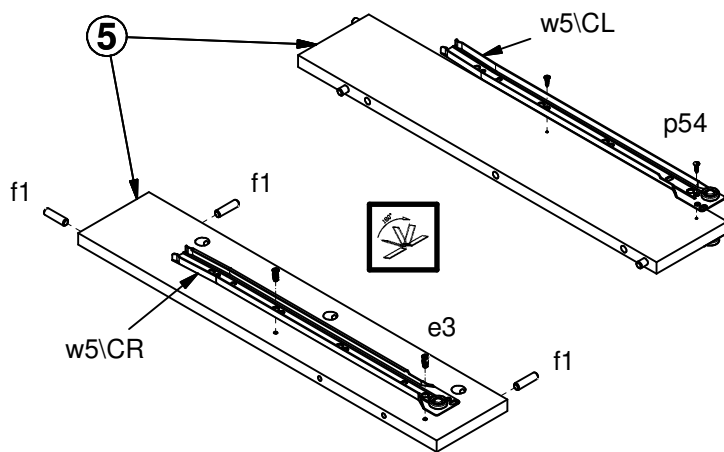
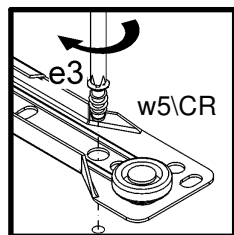

Zamontuj prowadnice w5\CR za pomocą 2 wkrętów e3 do elementu 5.
Zamontuj kołki f1 do elementu 5.
Obróć element 5.
Zamontuj prowadnice w5\CL za pomocą 2 wkrętów p54 do elementu 5.

4

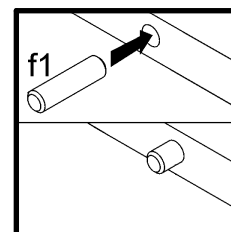
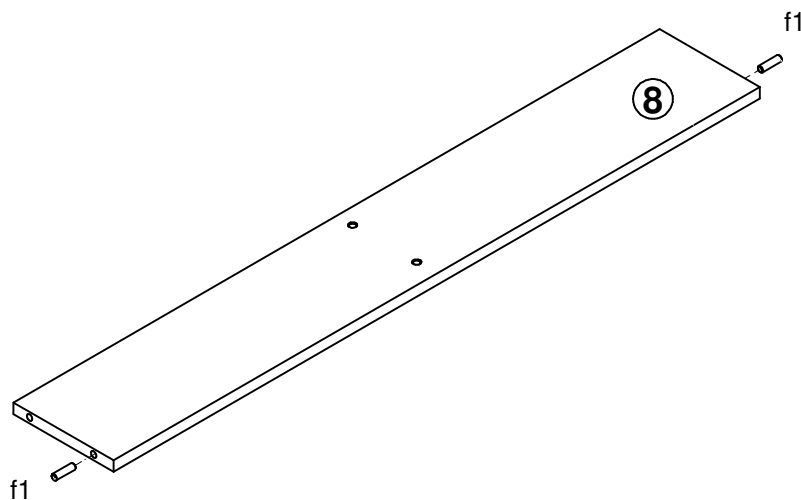

Zamontuj kołki f1 do elementu 8.

5

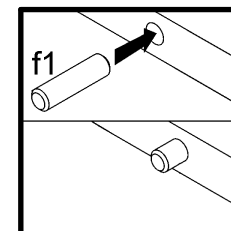
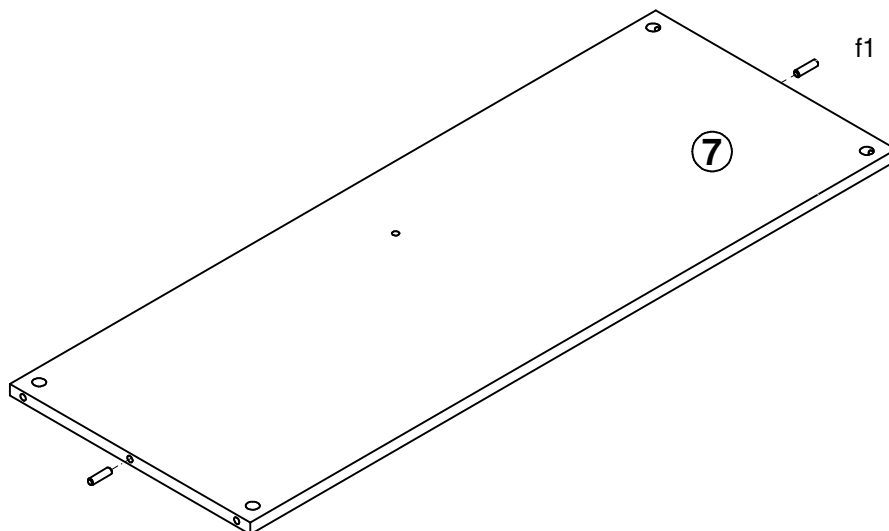

Zamontuj kołki f1 do elementu 7.

6

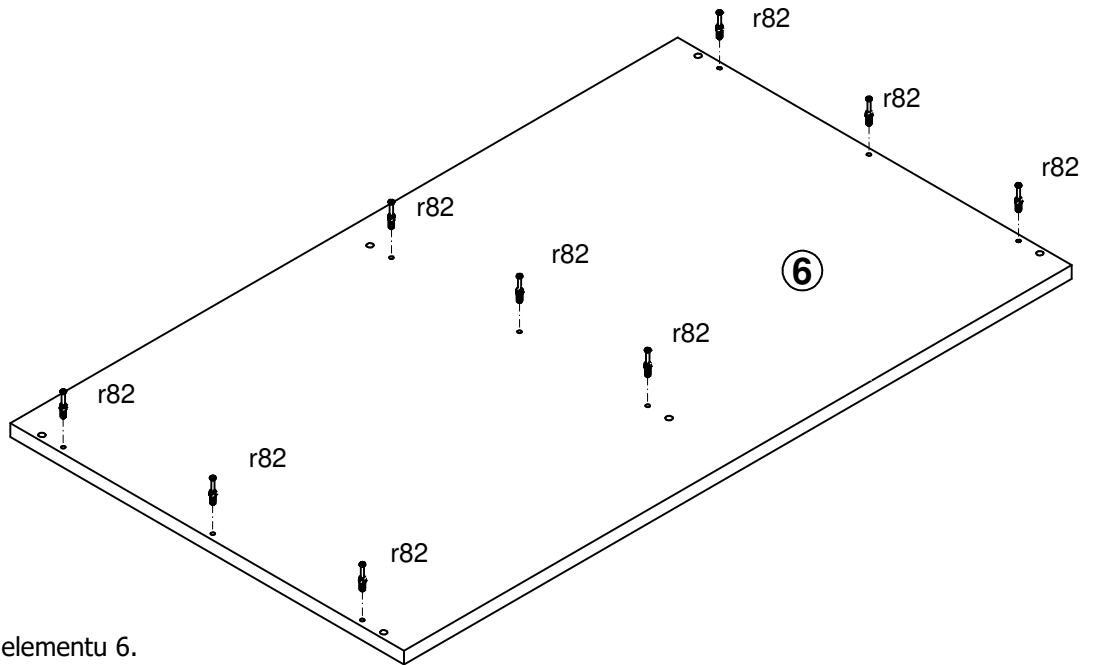
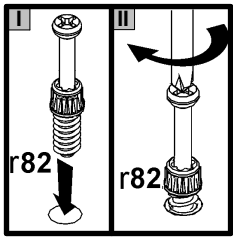

Zamontuj trzpienie r82 do elementu 6.

7

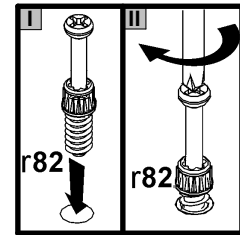
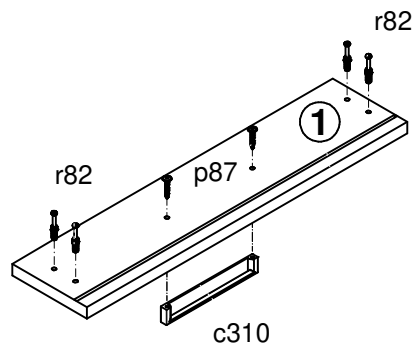

Zamontuj trzpienie r82 do elementu 1.
Zamontuj uchwyt c310 za pomocą wkrętów p87 do elementu 1.

8

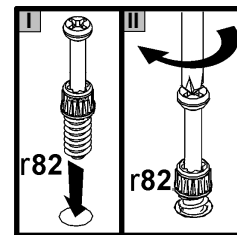
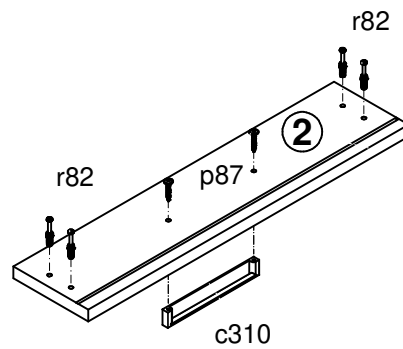

Zamontuj trzpienie r82 do elementu 2.
Zamontuj uchwyt c310 za pomocą wkrętów p87 do elementu 2.

9

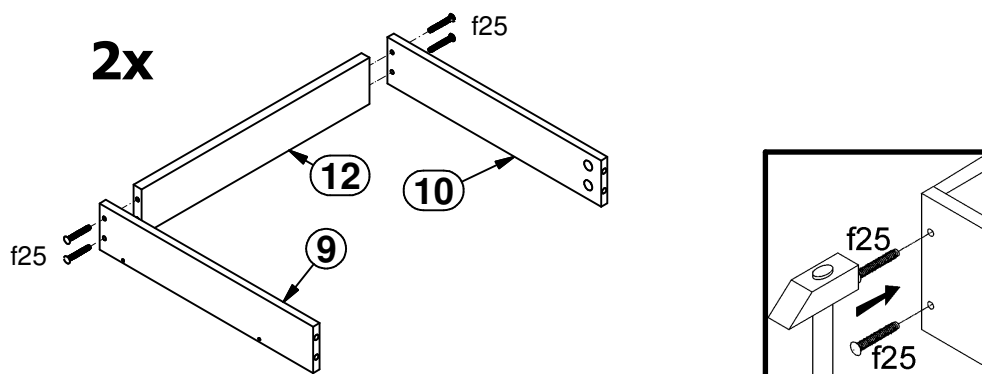

Złącz elementy 9 i 10 z elementem 12 za pomocą kołków f25 2 razy.

10

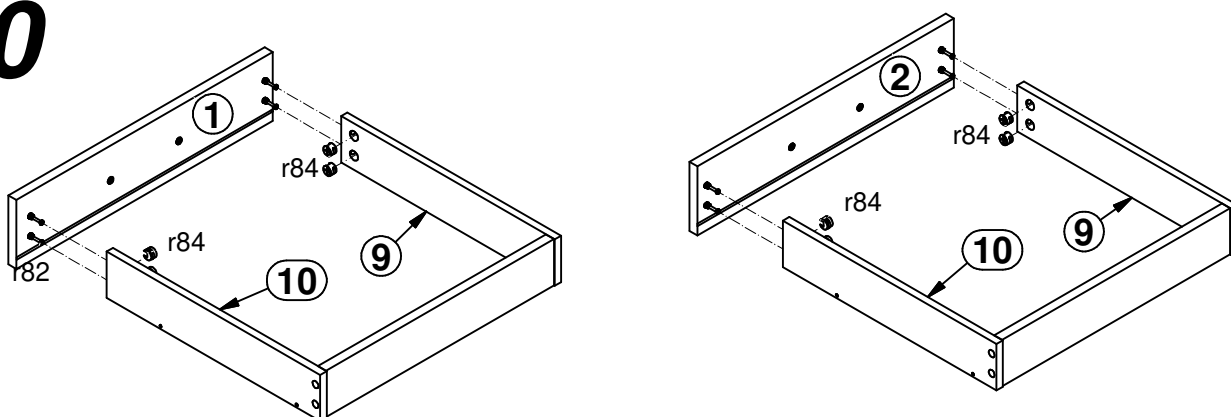

Złącz elementy 9 i 10 z elementem 1 za pomocą złącza mimośrodowego r84.
Złącz elementy 9 i 10 z elementem 2 za pomocą złącza mimośrodowego r84.

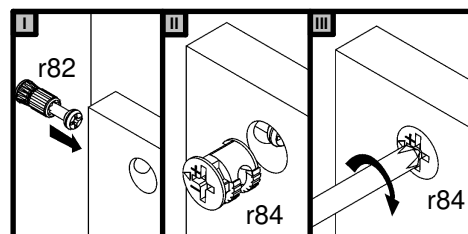

11

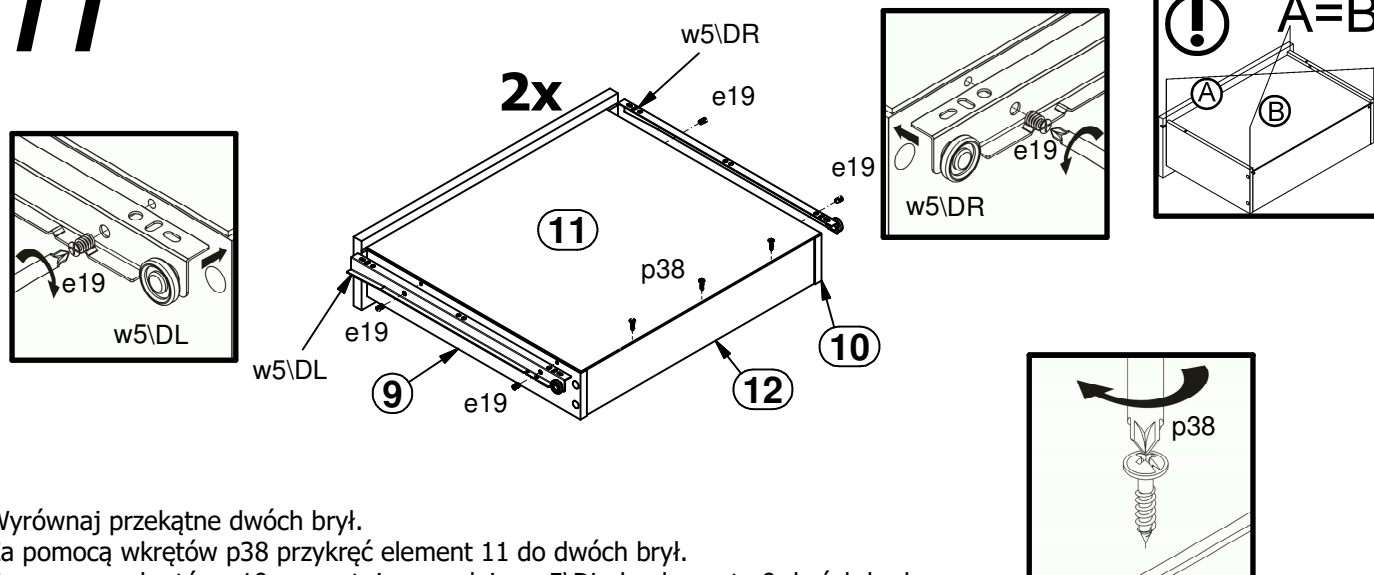

Wyrównaj przekątne dwóch brył.
Za pomocą wkrętów p38 przykręć element 11 do dwóch brył.
Za pomocą wkrętów e19 zamontuj prowadnice w5\DL do elementu 9 dwóch brył.
Za pomocą wkrętów e19 zamontuj prowadnice w5\DR do elementu 10 dwóch brył.

12

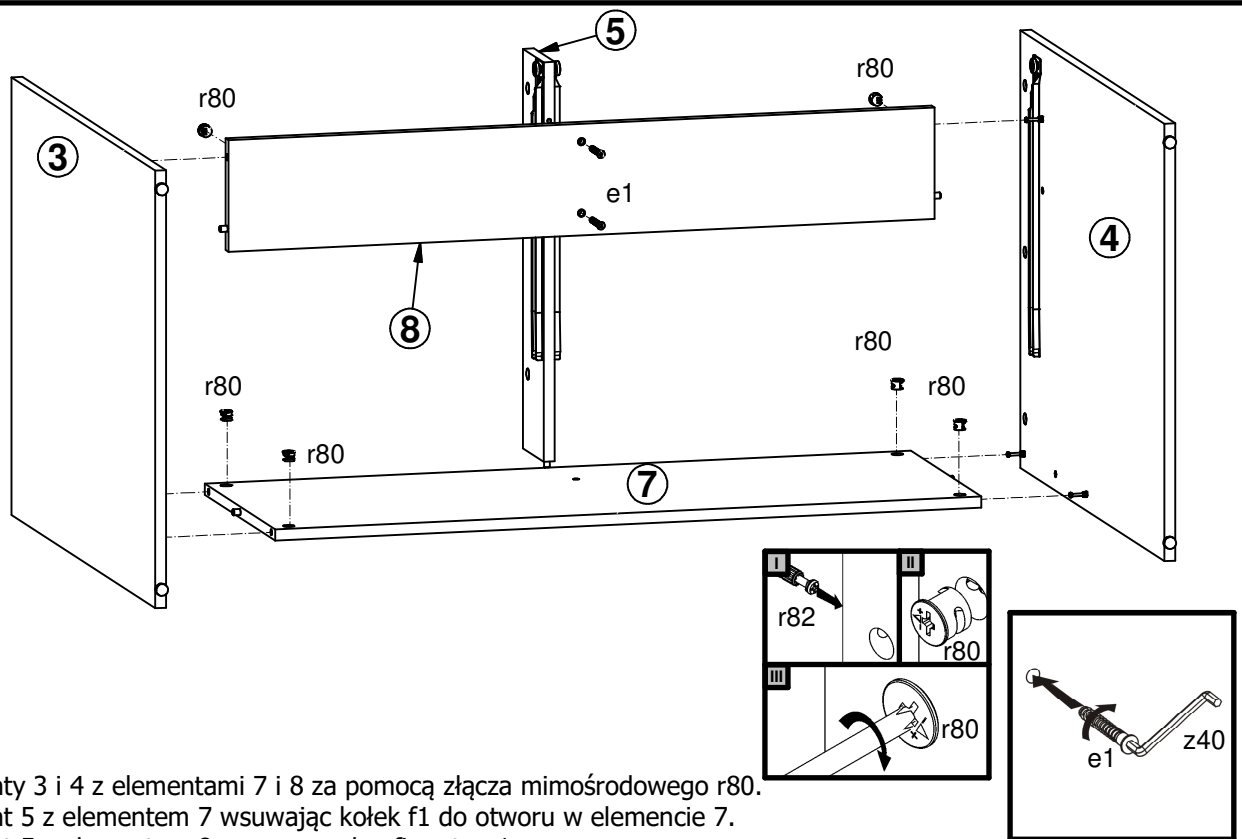

Złącz elementy 3 i 4 z elementami 7 i 8 za pomocą złącza mimośrodowego r80.
Złącz element 5 z elementem 7 wsuwając kołek f1 do otworu w elemencie 7.
Złącz element 5 z elementem 8 za pomocą konfirmatu e1.

13

Złącz element 6 z elementami 3, 4 i 5 za pomocą złącza mimośrodowego r80.

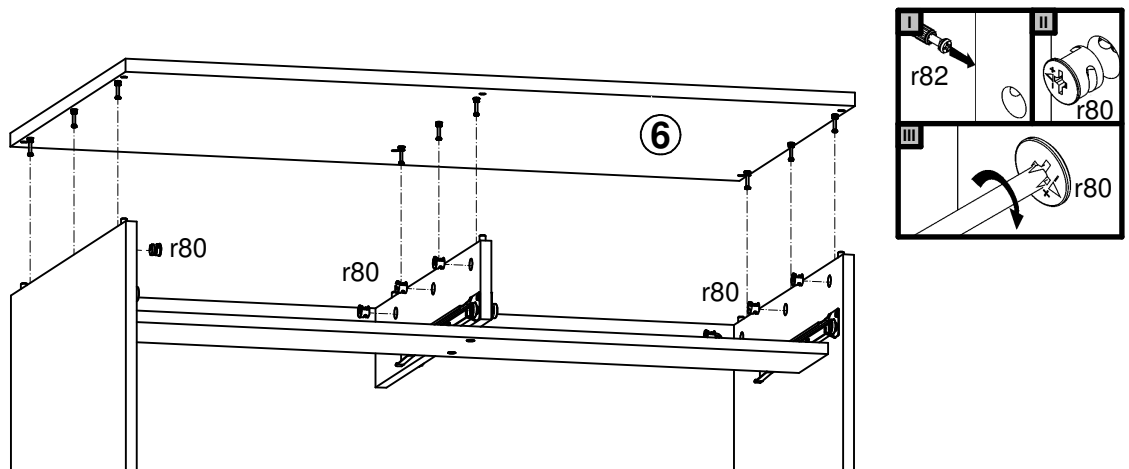

14

Zaślep widoczne minośrody za pomocą zaślepki s2.
Wsuń szuflady.

